

**GIKLB22-PD**

Rod end

Rod end GIKL..-PW, internal threads,
maintenance-free

Technical information

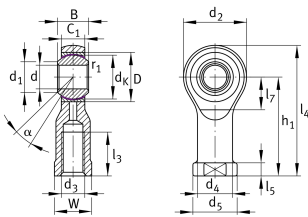

Your current product variant

| | |
|--------------------|------------------------|
| Clampable | Not clampable |
| Maintenance | Maintenance free |
| Lubrication nipple | Cannot be relubricated |
| Slotted | No |
| Thread Pitch | Left-hand thread |
| Sealing | Without |
| Mounting | Internal thread |

Main Dimensions & Performance Data

| | | |
|-------------|----------|-----------------------------------|
| C_r | 57.300 N | Basic dynamic load rating, radial |
| C_{0r} | 48.800 N | Basic static load rating, radial |
| d | 22 mm | Bore diameter bearing |
| d_2 | 55 mm | Outer eye diameter |
| l_4 | 111,5 mm | Total length internal thread head |
| $\approx m$ | 0,523 kg | Weight |



Dimensions

| | | |
|-------------------|-------------|--|
| C ₁ | 20 mm | Width of the rod end |
| D | 42 mm | Outside diameter bearing |
| B | 28 mm | Width inner ring |
| d _K | 38,1 mm | Ball diameter |
| d ₃ | M22x1,5 | Thread size |
| d ₄ | 30 mm | Shank diameter |
| d ₅ | 40 mm | Shank diameter, large |
| h ₁ | 84 mm | Shank Length Internal thread head |
| α | 15 ° | Tilt angle |
| l ₃ | 33 mm | Thread length Internal thread |
| l ₅ | 12 mm | Length rod end shank |
| l ₇ | 27 mm | Distance drilling with/shaft start |
| W | 32 mm | Width Across Flat |
| d _{UT} | 0 mm | Bore diameter bearing, lower tolerance |
| d _T | 0,021 | Bore diameter bearing, tolerance |
| d _{OT} | 0,021 mm | Bore diameter bearing, upper tolerance |
| B _{UT} | -0,21 mm | Width inner ring, lower tolerance |
| B _{OT} | 0 mm | Width inner ring, upper tolerance |
| G _r | 0,010-0,055 | Radial Clearance |
| G _{rmin} | 0,01 mm | Radial clearance, minimum |
| G _{rmax} | 0,055 mm | Radial clearance, maximum |

Mounting dimensions

| | | |
|--------------------|---------|----------------------------------|
| r _{1smin} | 0,3 mm | Edge Spacing |
| d ₁ | 25,8 mm | Outer flange diameter inner ring |



Temperature range

| | | |
|------------|--------|----------------------------|
| T_{\min} | -50 °C | Operating temperature min. |
| T_{\max} | 200 °C | Operating temperature max. |

Characteristics

-  Radial load
-  Axial load in one direction
-  Axial load in two directions
-  Lifetime lubrication, freedom from maintenance
-  Not sealed
-  Protected against rust
-  Static angular error and misalignment
-  Dynamic angular error and misalignment