

**GIHNRK200-LO**

Rod end



Hydraulic rod end, with thread clamping device, right hand thread, requiring maintenance, sliding contact surface: steel/steel, DIN 24338 ISO 6982, open design

Technical information

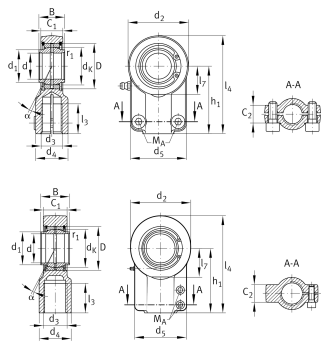
**Your current product variant**

Clampable	Clampable
Maintenance	Maintenance required
Mounting	Internal thread
Lubrication nipple	DIN71412-AS6 (tapered grease nipple)
Slotted	Slotted, one side
Thread Pitch	Right-hand thread
Type of Sealing	Without

Main Dimensions & Performance Data

C_r	2.760.000 N	Basic dynamic load rating, radial
C_{0r}	3.460.000 N	Basic static load rating, radial
d	200 mm	Bore diameter bearing
d_2	418 mm	Outer eye diameter
l_4	620 mm	Total length internal thread head
D	290 mm	Outside diameter bearing
B	200 mm	Width inner ring
$\approx m$	167 kg	Weight



Dimensions

α	4 °	Tilt angle
C ₁	162 mm	Width of the rod end
C ₂	102 mm	Width
d _K	250 mm	Ball diameter
d ₃	M160x4	Thread size
d ₄	215 mm	Shank diameter
d ₅	320 mm	Shank diameter, large
d ₇	M30x100	Diameter screw clamp
h ₁	390 mm	Shank Length Internal thread head
l ₃	161 mm	Thread length Internal thread
l ₇	195 mm	Distance drilling with/shaft start
d _{UT}	0 mm	Bore diameter bearing, lower tolerance
d _T	H7	Bore diameter bearing, tolerance
d _{OT}	0,046 mm	Bore diameter bearing, upper tolerance
B _{UT}	-0,46 mm	Width inner ring, lower tolerance
B _{OT}	0 mm	Width inner ring, upper tolerance
M _A	1.350 Nm	Tightening torque
F _Z	2.000.000 N	Cylinder Force
G _r	0,065 - 0,192	Radial Clearance
G _{rmin}	0,065 mm	Radial clearance, minimum
G _{rmax}	0,192 mm	Radial clearance, maximum

Mounting dimensions





r _{1smin}	1,1 mm	Edge Spacing
d ₁	221 mm	Outer flange diameter inner ring



Temperature range

T_{\min}	-60 °C	Operating temperature min.
T_{\max}	200 °C	Operating temperature max.

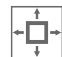
Characteristics

-  Radial load
-  Grease Lubrication
-  Not sealed
-  Large bearing
-  Static angular error and misalignment
-  Dynamic angular error and misalignment