

**GIHNRK32-LO**

## Rod end



Hydraulic rod end, with thread clamping device, right hand thread, requiring maintenance, sliding contact surface: steel/steel, DIN 24338 ISO 6982, open design

## Technical information

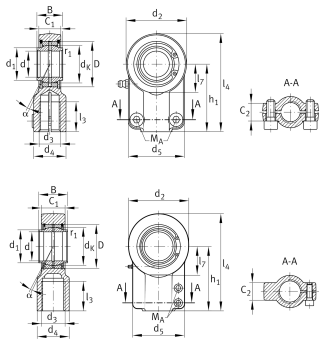

## Your current product variant

Clampable	Clampable
Maintenance	Maintenance required
Mounting	Internal thread
Lubrication nipple	DIN71412-AS6 (tapered grease nipple)
Slotted	Slotted, both sides
Thread Pitch	Right-hand thread
Type of Sealing	Without

## Main Dimensions &amp; Performance Data

$C_r$	87.500 N	Basic dynamic load rating, radial
$C_{0r}$	98.800 N	Basic static load rating, radial
$d$	32 mm	Bore diameter bearing
$d_2$	70 mm	Outer eye diameter
$l_4$	115 mm	Total length internal thread head
$D$	52 mm	Outside diameter bearing
$B$	32 mm	Width inner ring
$\approx m$	1,021 kg	Weight



## Dimensions

$\alpha$	4 °	Tilt angle
C 1	27 mm	Width of the rod end
C 2	22 mm	Width
d K	44 mm	Ball diameter
d 3	M27x2	Thread size
d 4	38 mm	Shank diameter
d 5	66 mm	Shank diameter, large
d 7	M10x25	Diameter screw clamp
h 1	80 mm	Shank Length Internal thread head
l 3	37 mm	Thread length Internal thread
l 7	32 mm	Distance drilling with/shaft start
d UT	0 mm	Bore diameter bearing, lower tolerance
d T	H7	Bore diameter bearing, tolerance
d OT	0,025 mm	Bore diameter bearing, upper tolerance
B UT	-0,25 mm	Width inner ring, lower tolerance
B OT	0 mm	Width inner ring, upper tolerance
M A	64 Nm	Tightening torque
F Z	50.000 N	Cylinder Force
G r	0,037 - 0,1	Radial Clearance
G rmin	0,037 mm	Radial clearance, minimum
G rmax	0,1 mm	Radial clearance, maximum

## Mounting dimensions

r 1smin	0,6 mm	Edge Spacing
d 1	38 mm	Outer flange diameter inner ring







### Temperature range

---

$T_{\min}$	-60 °C	Operating temperature min.
$T_{\max}$	200 °C	Operating temperature max.

### Characteristics

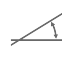
---

-  Radial load
-  Grease Lubrication
-  Not sealed
-  Static angular error and misalignment
-  Dynamic angular error and misalignment