

**GE480-DW-2RS2-XL**

Spherical plain bearing

Large radial spherical plain bearing, maintenance-free, sliding layer: ELGOGLIDE, inner ring curved surface with hard chromium coating, DIN ISO 12240-1, dimension series C, sealed

X-life

Technical information

Your current product variant

Maintenance	Maintenance free
Type of Seal	2RS2 Lip seals with increased sealing action on both sides
Bore lining	Without
Coating	Without
Fabric	ELGOGLIDE
Material	Steel

Main Dimensions & Performance Data

d	480 mm	Bore diameter bearing
C_r	28.300.000 N	Basic dynamic load rating, radial
D	650 mm	Outside diameter bearing
B	230 mm	Width inner ring
C	195 mm	Width Outer ring
C_{0r}	47.200.000 N	Basic static load rating, radial
$\approx m$	233,1 kg	Weight

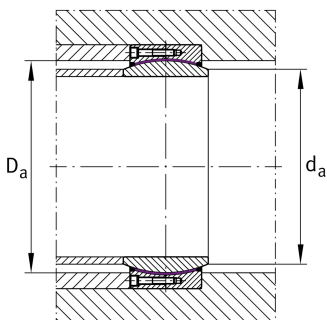
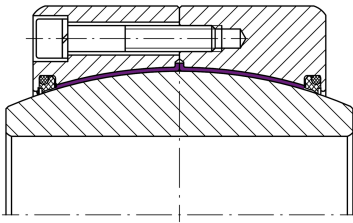



Mounting dimensions

$r_{1\text{min}}$	2 mm	Edge Spacing
$r_{2\text{min}}$	5 mm	Edge Spacing
D_{amin}	536 mm	Housing Connection Diameter
d_{amax}	516 mm	Connection measurement, inner ring

Dimensions

d_{κ}	565 mm	Ball diameter
α	3,8 °	Tilt angle
D_{OT}	0 mm	Outside diameter, upper tolerance
D_{UT}	-0,075 mm	Outside diameter, lower tolerance
B_{OT}	0 mm	Width inner ring, upper tolerance
d_{UT}	-0,045 mm	Bore diameter bearing, lower tolerance
B_{UT}	-0,45 mm	Width inner ring, lower tolerance
d_{OT}	0 mm	Bore diameter bearing, upper tolerance
C_{OT}	0 mm	Width outer ring, upper tolerance
C_{UT}	-1,1 mm	Width outer ring, lower tolerance
G_{r}	0 - 0,145	Radial Clearance
G_{rmax}	0,145 mm	Radial clearance, maximum
G_{rmin}	0 mm	Radial clearance, minimum

Temperature range

T_{min}	-40 °C	Operating temperature min.
T_{max}	120 °C	Operating temperature max.



Characteristics

-  Radial load
-  Axial load in one direction
-  Axial load in two directions
-  Lifetime lubrication, freedom from maintenance
-  Sealed on both sides
-  Large bearing
-  Static angular error and misalignment
-  Dynamic angular error and misalignment