

**GE340-AW-XL**

## Spherical plain bearing

Spherical plain bearing GE...-AW-A-XL, axial/  
oblique, maintenance-free

X-life

## Technical information

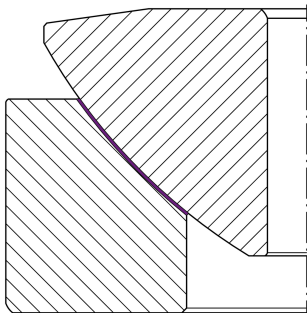
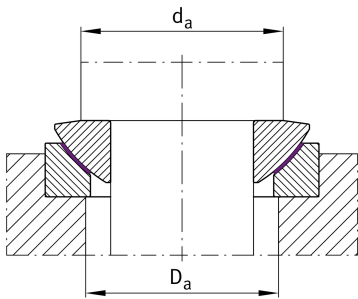
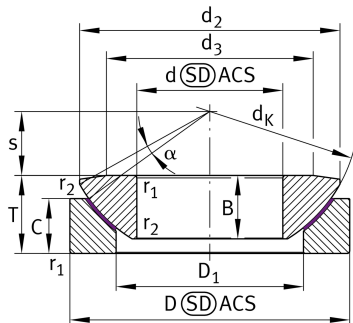

## Your current product variant

Maintenance	Maintenance free
Coating	Without
Material sliding Layer	ELGOGLIDE

## Main Dimensions &amp; Performance Data

d	340 mm	Bore diameter bearing
D	540 mm	Outside diameter bearing
T	116 mm	Height
B	105 mm	Width inner ring
C <sub>a</sub>	23.700.000 N	Basic dynamic load rating, axial
C <sub>0a</sub>	39.500.000 N	Basic static load rating, axial
≈m	116,8 kg	Weight

## Mounting dimensions

r <sub>1smin</sub>	4 mm	Edge Spacing
r <sub>2smin</sub>	1,1 mm	Edge Spacing
d <sub>a max</sub>	432 mm	Connection measure Inner ring
D <sub>a min</sub>	402 mm	Housing Connection Diameter



### Dimensions

$d_K$	550 mm	Ball diameter
$d_2$	510 mm	Outer eye diameter
$d_3$	432 mm	Front surface diameter of shaft washer
$D_1$	380 mm	Bore diameter of housing washer
$C$	91 mm	Width Outer ring
$s$	95 mm	Plane Surface Spacing
$\alpha$	4 °	Tilt angle
$d_{OT}$	0 mm	Bore diameter bearing, upper tolerance
$d_{UT}$	-0,04 mm	Bore diameter bearing, lower tolerance
$D_{OT}$	0 mm	Outside diameter, upper tolerance
$D_{UT}$	-0,05 mm	Outside diameter, lower tolerance
$T_{OT}$	0 mm	Height, upper tolerance
$B_{OT}$	0 mm	Width inner ring, upper tolerance
$T_{UT}$	-0,8 mm	Height, lower tolerance
$B_{UT}$	-0,8 mm	Width inner ring, lower tolerance
$C_{OT}$	0 mm	Width outer ring, upper tolerance
$C_{UT}$	-0,8 mm	Width outer ring, lower tolerance

### Temperature range

$T_{min}$	-50 °C	Operating temperature min.
$T_{max}$	150 °C	Operating temperature max.



## Characteristics

---



Radial load



Axial load in one direction



Lifetime lubrication, freedom from maintenance



Not sealed



Large bearing



Static angular error and misalignment



Dynamic angular error and misalignment