

**GE280-AW-XL**

Spherical plain bearing

Spherical plain bearing GE...-AW-A-XL, axial/
oblique, maintenance-free

X-life

Technical information

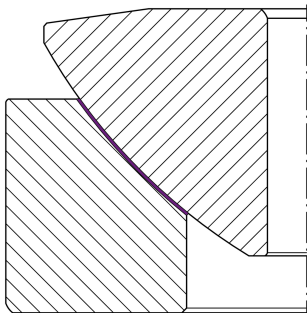
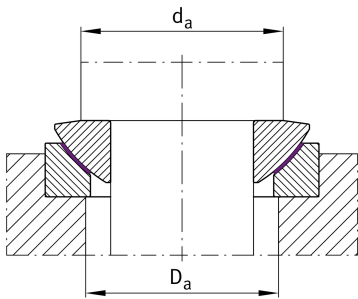
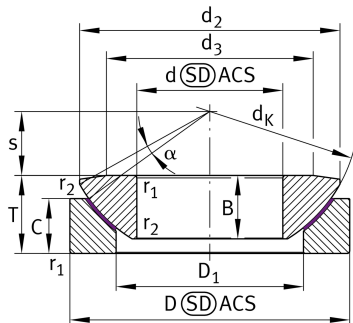

Your current product variant

Maintenance	Maintenance free
Coating	Without

Main Dimensions & Performance Data

d	280 mm	Bore diameter bearing
D	460 mm	Outside diameter bearing
T	110 mm	Height
B	100 mm	Width inner ring
C _a	17.100.000 N	Basic dynamic load rating, axial
C _{0a}	28.600.000 N	Basic static load rating, axial
≈m	84,8 kg	Weight

Mounting dimensions

r _{1smin}	3 mm	Edge Spacing
r _{2smin}	1 mm	Edge Spacing
d _{a max}	366 mm	Connection measure Inner ring
D _{a min}	355 mm	Housing Connection Diameter



Dimensions







d_K	480 mm	Ball diameter
d_2	445 mm	Outer eye diameter
d_3	366 mm	Front surface diameter of shaft washer
D_1	337 mm	Bore diameter of housing washer
C	85 mm	Width Outer ring
s	80 mm	Plane Surface Spacing
α	4 °	Tilt angle
d_{OT}	0 mm	Bore diameter bearing, upper tolerance
d_{UT}	-0,035 mm	Bore diameter bearing, lower tolerance
D_{OT}	0 mm	Outside diameter, upper tolerance
D_{UT}	-0,045 mm	Outside diameter, lower tolerance
T_{OT}	0 mm	Height, upper tolerance
B_{OT}	0 mm	Width inner ring, upper tolerance
T_{UT}	-0,7 mm	Height, lower tolerance
B_{UT}	-0,7 mm	Width inner ring, lower tolerance
C_{OT}	0 mm	Width outer ring, upper tolerance
C_{UT}	-0,7 mm	Width outer ring, lower tolerance

Temperature range

T_{min}	-50 °C	Operating temperature min.
T_{max}	150 °C	Operating temperature max.



Characteristics

-  Radial load
-  Axial load in one direction
-  Lifetime lubrication, freedom from maintenance
-  Not sealed
-  Large bearing
-  Static angular error and misalignment
-  Dynamic angular error and misalignment