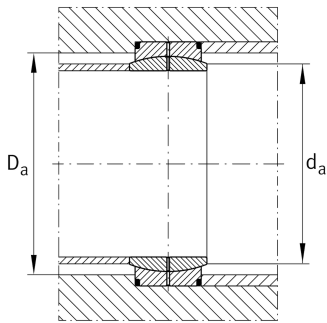

**GE460-DO**

Spherical plain bearing

Radial spherical plain bearing, requiring maintenance, sliding contact surface: steel/steel, DIN ISO 12240-1, dimension series C, open design

Technical information

**Your current product variant**

Maintenance	Maintenance required
Material	Steel
Sealing	Without
Radial internal clearance	CN (Group N) Normal internal clearance
Coating	Durotect M Inner- and outer ring coated with Durotect M (Manganese Phosphate)

Main Dimensions & Performance Data

d	460 mm	Bore diameter bearing
D	620 mm	Outside diameter bearing
B	218 mm	Width inner ring
C _r	12.500.000 N	Basic dynamic load rating, radial
C _{0r}	48.200.000 N	Basic static load rating, radial
≈m	200,7 kg	Weight

Mounting dimensions

r _{1smin}	1,5 mm	Edge Spacing
r _{2smin}	4 mm	Edge Spacing
d _{a max}	494 mm	Connection measure Inner ring
D _{a min}	513 mm	Housing Connection Diameter



Dimensions

C	185 mm	Width Outer ring
d _K	540 mm	Ball diameter
α	3,7 °	Tilt angle
d _{OT}	0 mm	Bore diameter bearing, upper tolerance
d _{UT}	-0,045 mm	Bore diameter bearing, lower tolerance
D _{OT}	0 mm	Outside diameter, upper tolerance
D _{UT}	-0,05 mm	Outside diameter, lower tolerance
B _{OT}	0 mm	Width inner ring, upper tolerance
B _{UT}	-0,45 mm	Width inner ring, lower tolerance
C _{OT}	0 mm	Width outer ring, upper tolerance
C _{UT}	-1 mm	Width outer ring, lower tolerance
G _r	0,145 - 0,285	Radial Clearance
G _{rmax}	0,285 mm	Radial clearance, maximum
G _{rmin}	0,145 mm	Radial clearance, minimum

Temperature range

T _{min}	-60 °C	Operating temperature min.
T _{max}	200 °C	Operating temperature max.



Characteristics



Radial load



Axial load in one direction



Axial load in two directions



Grease Lubrication



Not sealed



Large bearing



Static angular error and misalignment



Dynamic angular error and misalignment