

**GE100-LO**

Spherical plain bearing

High performance Radial spherical plain bearing, requiring maintenance, sliding contact surface: steel/steel, DIN ISO 12240-1, dimension series W, cylindrical extensions on inner ring, open design High-performance: For highest load rating and lifetime demands

Technical information

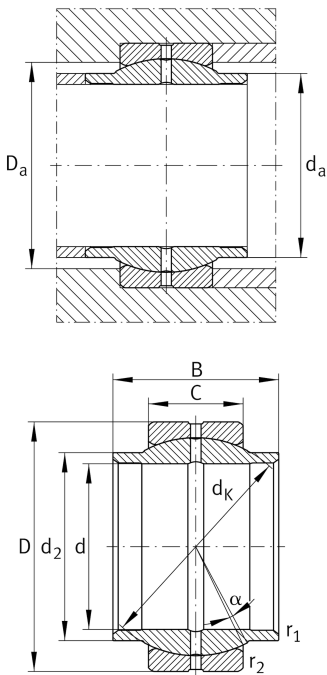

Your current product variant

| | |
|---------------------------|---|
| Maintenance | Maintenance required |
| Material | Steel |
| Sealing | Without |
| Radial internal clearance | CN (Group N) Normal internal clearance |
| Coating | Durotect M Inner- and outer ring coated with Durotect M (Manganese Phosphate) |

Main Dimensions & Performance Data

| | | |
|-----------------|-------------|-----------------------------------|
| d | 100 mm | Bore diameter bearing |
| D | 150 mm | Outside diameter bearing |
| B | 100 mm | Width inner ring |
| C _r | 790.000 N | Basic dynamic load rating, radial |
| C _{0r} | 3.040.000 N | Basic static load rating, radial |
| ≈m | 4,888 kg | Weight |

Mounting dimensions

| | | |
|--------------------|--------|-------------------------------|
| r _{1smin} | 1 mm | Edge Spacing |
| r _{2smin} | 1 mm | Edge Spacing |
| d _{a max} | 113 mm | Connection measure Inner ring |
| D _{a min} | 123 mm | Housing Connection Diameter |



Dimensions

| | | |
|-------------------|---------------|--|
| C | 55 mm | Width Outer ring |
| d _K | 130 mm | Ball diameter |
| α | 4 ° | Tilt angle |
| d _{OT} | 0,035 mm | Bore diameter bearing, upper tolerance |
| d _{UT} | 0 mm | Bore diameter bearing, lower tolerance |
| D _{OT} | 0 mm | Outside diameter, upper tolerance |
| D _{UT} | -0,018 mm | Outside diameter, lower tolerance |
| B _{OT} | 0 mm | Width inner ring, upper tolerance |
| B _{UT} | -0,35 mm | Width inner ring, lower tolerance |
| C _{OT} | 0 mm | Width outer ring, upper tolerance |
| C _{UT} | -0,5 mm | Width outer ring, lower tolerance |
| G _r | 0,085 - 0,165 | Radial Clearance |
| G _{rmax} | 0,165 mm | Radial clearance, maximum |
| G _{rmin} | 0,085 mm | Radial clearance, minimum |

Temperature range

| | | |
|------------------|--------|----------------------------|
| T _{min} | -60 °C | Operating temperature min. |
| T _{max} | 200 °C | Operating temperature max. |

Characteristics

| | |
|---|--|
|  | Radial load |
|  | Axial load in one direction |
|  | Axial load in two directions |
|  | Grease Lubrication |
|  | Not sealed |
|  | Static angular error and misalignment |
|  | Dynamic angular error and misalignment |