

**GE12-LO**

Spherical plain bearing

High performance Radial spherical plain bearing, requiring maintenance, sliding contact surface: steel/steel, DIN ISO 12240-1, dimension series W, cylindrical extensions on inner ring, open design High-performance: For highest load rating and lifetime demands

Technical information

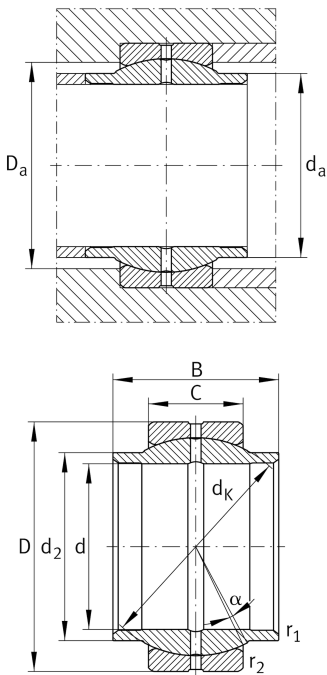

Your current product variant

| | | |
|---------------------------|----------------------|--|
| Maintenance | Maintenance required | |
| Material | Steel | |
| Type of Sealing | Without | |
| Radial internal clearance | CN (Group N) | Normal internal clearance |
| Coating | Durotect M | Inner- and outer ring coated with Durotect M (Manganese Phosphate) |

Main Dimensions & Performance Data

| | | |
|-----------------|----------|-----------------------------------|
| d | 12 mm | Bore diameter bearing |
| D | 22 mm | Outside diameter bearing |
| B | 12 mm | Width inner ring |
| C _r | 13.900 N | Basic dynamic load rating, radial |
| C _{0r} | 53.600 N | Basic static load rating, radial |
| ≈m | 16,85 g | Weight |

Mounting dimensions

| | | |
|--------------------|---------|-------------------------------|
| r _{1smin} | 0,3 mm | Edge Spacing |
| r _{2smin} | 0,3 mm | Edge Spacing |
| d _{a max} | 15,5 mm | Connection measure Inner ring |
| D _{a min} | 17,5 mm | Housing Connection Diameter |



Dimensions

| | | |
|------------|---------------|--|
| C | 7 mm | Width Outer ring |
| d_K | 18 mm | Ball diameter |
| α | 4 ° | Tilt angle |
| d_{OT} | 0,018 mm | Bore diameter bearing, upper tolerance |
| d_{UT} | 0 mm | Bore diameter bearing, lower tolerance |
| D_{OT} | 0 mm | Outside diameter, upper tolerance |
| D_{UT} | -0,009 mm | Outside diameter, lower tolerance |
| B_{OT} | 0 mm | Width inner ring, upper tolerance |
| B_{UT} | -0,18 mm | Width inner ring, lower tolerance |
| C_{OT} | 0 mm | Width outer ring, upper tolerance |
| C_{UT} | -0,24 mm | Width outer ring, lower tolerance |
| G_r | 0,032 - 0,068 | Radial Clearance |
| G_{rmax} | 0,068 mm | Radial clearance, maximum |
| G_{rmin} | 0,032 mm | Radial clearance, minimum |

Temperature range

| | | |
|-----------|--------|----------------------------|
| T_{min} | -60 °C | Operating temperature min. |
| T_{max} | 200 °C | Operating temperature max. |

Characteristics

-  Radial load
-  Axial load in one direction
-  Axial load in two directions
-  Grease Lubrication
-  Not sealed
-  Static angular error and misalignment
-  Dynamic angular error and misalignment