

**GE70-LO**

Spherical plain bearing

High performance Radial spherical plain bearing, requiring maintenance, sliding contact surface: steel/steel, DIN ISO 12240-1, dimension series W, cylindrical extensions on inner ring, open design High-performance: For highest load rating and lifetime demands

Technical information

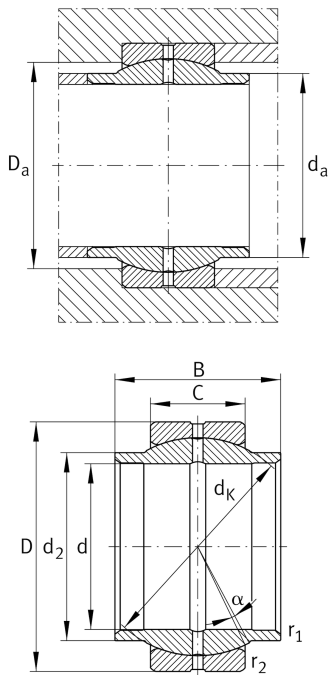

Your current product variant

Maintenance	Maintenance required
Material	Steel
Sealing	Without
Radial internal clearance	CN (Group N) Normal internal clearance
Coating	Durotect M Inner- and outer ring coated with Durotect M (Manganese Phosphate)

Main Dimensions & Performance Data

d	70 mm	Bore diameter bearing
D	105 mm	Outside diameter bearing
B	70 mm	Width inner ring
C _r	407.000 N	Basic dynamic load rating, radial
C _{0r}	1.560.000 N	Basic static load rating, radial
≈m	1,71 kg	Weight

Mounting dimensions

r _{1smin}	1 mm	Edge Spacing
r _{2smin}	1 mm	Edge Spacing
d _{a max}	79 mm	Connection measure Inner ring
D _{a min}	87 mm	Housing Connection Diameter









Dimensions

C	40 mm	Width Outer ring
d_K	92 mm	Ball diameter
α	4 °	Tilt angle
d_{OT}	0,03 mm	Bore diameter bearing, upper tolerance
d_{UT}	0 mm	Bore diameter bearing, lower tolerance
D_{OT}	0 mm	Outside diameter, upper tolerance
D_{UT}	-0,015 mm	Outside diameter, lower tolerance
B_{OT}	0 mm	Width inner ring, upper tolerance
B_{UT}	-0,3 mm	Width inner ring, lower tolerance
C_{OT}	0 mm	Width outer ring, upper tolerance
C_{UT}	-0,4 mm	Width outer ring, lower tolerance
G_r	0,072 - 0,142	Radial Clearance
G_{rmax}	0,142 mm	Radial clearance, maximum
G_{rmin}	0,072 mm	Radial clearance, minimum

Temperature range

T_{min}	-60 °C	Operating temperature min.
T_{max}	200 °C	Operating temperature max.

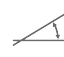
Characteristics

	Radial load
	Axial load in one direction
	Axial load in two directions
	Grease Lubrication
	Not sealed
	Static angular error and misalignment
	Dynamic angular error and misalignment