

**GE120-SX-F10**

Spherical plain bearing



Angular contact spherical plain bearing,
requiring maintenance, sliding contact
surface: steel/steel, DIN ISO 12240-2, open
design

Technical information

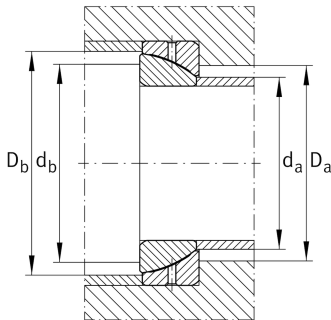
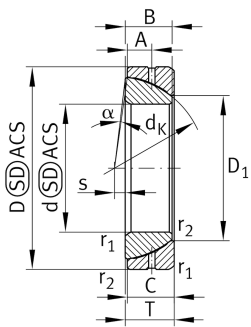
**Your current product variant**

Maintenance	Maintenance required	
Coating	Durotect M	Inner- and outer ring coated with Durotect M (Manganese Phosphate)
Lubrication Groove System	F10	Lubrication groove system for oil bath lubrication for angular contact spherical plain bearings GE.-SX

Main Dimensions & Performance Data

d	120 mm	Inner diameter bearing
D	180 mm	Outside diameter bearing
T	38 mm	Height
C _r	649.000 N	Basic dynamic load rating, radial
C _{0r}	1.250.000 N	Basic static load rating, radial
≈m	4,06 kg	Weight

Mounting dimensions

r _{1min}	2,5 mm	Edge Spacing
r _{2min}	0,6 mm	Edge Spacing
d _{a max}	132,9 mm	Connection measure Inner ring
D _{a min}	145 mm	Housing Connection Diameter
D _{b min}	172 mm	Connection diameter



Dimensions

d_K	170 mm	Ball diameter
D_1	135,4 mm	Inner diameter of housing washer
B	36 mm	Width Inner ring
C	36 mm	Width Outer ring
s	17 mm	Plane Surface Spacing
A	19 mm	Distance lubrication Bore
α	1,4 °	Tilt angle
d_{OT}	0 mm	Bore diameter bearing, upper tolerance
d_{UT}	-0,02 mm	Bore diameter bearing, lower tolerance
D_{OT}	0 mm	Outer diameter, upper tolerance
D_{UT}	-0,025 mm	Outside diameter, lower tolerance
T_{OT}	0,25 mm	Height, upper tolerance
T_{UT}	-0,25 mm	Height, lower tolerance
C_{UT}	0 mm	Width outer ring, upper tolerance
C_{OT}	-0,4 mm	Width outer ring, lower tolerance
B_{OT}	0 mm	Width inner ring, upper tolerance
B_{UT}	-0,4 mm	Width inner ring, lower tolerance
d_2	155 mm	Connection measure Inner ring

Temperature range

T_{min}	-60 °C	Operating temperature min.
T_{max}	200 °C	Operating temperature max.



Characteristics



Radial load



Axial load in one direction



Grease Lubrication



Not sealed



Static angular error and misalignment



Dynamic angular error and misalignment