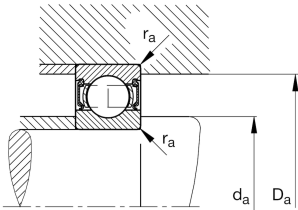
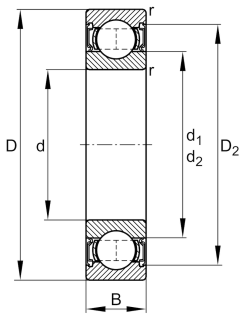

**FAG****6013-2RSR**

Deep groove ball bearing

Deep groove ball bearing 60..-2RSR, single row, seals, steel sheet metal cage

Technical information

**Your current product variant**

Sealing	2RSR	Contact seal on both sides
Cage	JN	Steel sheet metal
Tolerance class	PN	Normal (PN)
Dimensional / heat stabilization	S0	Rings dimensional stabilized up to 150°
Lubricant	GA13	Ball bearing and insert bearing grease
Radial internal clearance	CN (Group N)	Normal internal clearance
Bore type	Z	Cylindrical

Main Dimensions & Performance Data

d	65 mm	Bore diameter
D	100 mm	Outside diameter
B	18 mm	Width
C _r	32.500 N	Basic dynamic load rating, radial
C _{0r}	25.000 N	Basic static load rating, radial
C _{ur}	1.300 N	Fatigue load limit, radial
n _G	3.500 1/min	Limiting speed
m	0,437 kg	Weight

Mounting dimensions

d _{a min}	71 mm	Minimum diameter shaft shoulder
D _{a max}	94 mm	Maximum diameter of housing shoulder
r _{a max}	1 mm	Maximum fillet radius



Dimensions

r_{\min}	1,1 mm	Minimum chamfer dimension
D_1	88,8 mm	Shoulder diameter outer ring
D_2	91,52 mm	Caliber diameter outer ring
d_1	76,225 mm	Shoulder diameter inner ring

Temperature range

T_{\min}	-20 °C	Operating temperature min.
T_{\max}	100 °C	Operating temperature max.

Calculation factors

f_0	15,7	Calculation factor
-------	------	--------------------

Characteristics



Radial load



Axial load in one direction



Axial load in two directions



Lifetime lubrication, freedom from maintenance



Grease Lubrication



Sealed on both sides