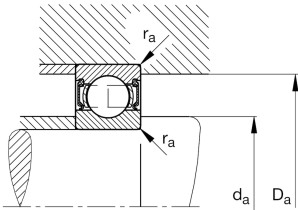
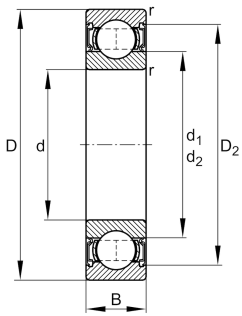

**FAG****6032-2RSR**

Deep groove ball bearing

Deep groove ball bearing 60...-2RSR, single row, seals, steel sheet metal cage

Technical information

**Your current product variant**

| | | |
|----------------------------------|--------------|---|
| Type of Seal | 2RSR | Contact seal on both sides |
| Cage | JN | Steel sheet metal |
| Tolerance class | PN | Normal (PN) |
| Dimensional / heat stabilization | S0 | Rings dimensional stabilized up to 150° |
| Lubricant | GA13 | Ball bearing and insert bearing grease |
| Radial internal clearance | CN (Group N) | Normal internal clearance |
| Bore type | Z | Cylindrical |

Main Dimensions & Performance Data

| | | |
|-----------------|-------------|-----------------------------------|
| d | 160 mm | Bore diameter |
| D | 240 mm | Outside diameter |
| B | 38 mm | Width |
| C _r | 142.000 N | Basic dynamic load rating, radial |
| C _{0r} | 136.000 N | Basic static load rating, radial |
| C _{ur} | 6.000 N | Fatigue load limit, radial |
| n _G | 1.440 1/min | Limiting speed |
| m | 5,47 kg | Weight |

Mounting dimensions

| | | |
|--------------------|----------|--------------------------------------|
| d _{a min} | 170,2 mm | Minimum diameter shaft shoulder |
| D _{a max} | 229,8 mm | Maximum diameter of housing shoulder |
| r _{a max} | 2,1 mm | Maximum fillet radius |



Dimensions

| | | |
|------------|-----------|------------------------------|
| r_{\min} | 2,1 mm | Minimum chamfer dimension |
| D_1 | 214,62 mm | Shoulder diameter outer ring |
| D_2 | 219,68 mm | Caliber diameter outer ring |
| d_1 | 185,75 mm | Shoulder diameter inner ring |

Temperature range

| | | |
|------------|--------|----------------------------|
| T_{\min} | -20 °C | Operating temperature min. |
| T_{\max} | 100 °C | Operating temperature max. |

Calculation factors

| | | |
|-------|----|--------------------|
| f_0 | 16 | Calculation factor |
|-------|----|--------------------|

Characteristics



Radial load



Axial load in one direction



Axial load in two directions



Lifetime lubrication, freedom from maintenance



Grease Lubrication



Sealed on both sides