

**FAG****6019-2Z-C3**

Deep groove ball bearing

Deep groove ball bearing 60...-2Z, single row, shields, steel sheet metal cage

Technical information

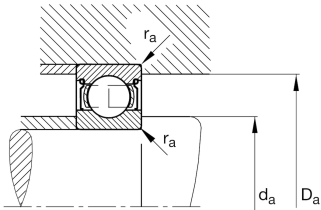

Your current product variant

| | | |
|----------------------------------|--------------|---|
| Sealing | 2Z | Non-contact shield on both sides |
| Cage | JN | Steel sheet metal |
| Tolerance class | PN | Normal (PN) |
| Dimensional / heat stabilization | S0 | Rings dimensional stabilized up to 150° |
| Lubricant | GA13 | Ball bearing and insert bearing grease |
| Radial internal clearance | C3 (Group 3) | Internal clearance larger than CN |
| Bore type | Z | Cylindrical |

Main Dimensions & Performance Data

| | | |
|-----------------|-------------|-----------------------------------|
| d | 95 mm | Bore diameter |
| D | 145 mm | Outside diameter |
| B | 24 mm | Width |
| C _r | 64.000 N | Basic dynamic load rating, radial |
| C _{0r} | 54.000 N | Basic static load rating, radial |
| C _{ur} | 3.150 N | Fatigue load limit, radial |
| n _G | 5.400 1/min | Limiting speed |
| n _{gr} | 5.300 1/min | Reference speed |
| ≈m | 1,29 kg | Weight |



Mounting dimensions

| | | |
|--------------|--------|--------------------------------------|
| $d_{a \min}$ | 102 mm | Minimum diameter shaft shoulder |
| $D_{a \max}$ | 138 mm | Maximum diameter of housing shoulder |
| $r_{a \max}$ | 1,5 mm | Maximum fillet radius |

Dimensions

| | | |
|------------|-----------|------------------------------|
| r_{\min} | 1,5 mm | Minimum chamfer dimension |
| D_1 | 129,12 mm | Shoulder diameter outer ring |
| D_2 | 131,84 mm | Caliber diameter outer ring |
| d_1 | 110,6 mm | Shoulder diameter inner ring |

Temperature range

| | | |
|------------|--------|----------------------------|
| T_{\min} | -20 °C | Operating temperature min. |
| T_{\max} | 120 °C | Operating temperature max. |

Calculation factors

| | | |
|-------|------|--------------------|
| f_0 | 15,8 | Calculation factor |
|-------|------|--------------------|

Characteristics

| | |
|---|--|
|  | Radial load |
|  | Axial load in one direction |
|  | Axial load in two directions |
|  | Lifetime lubrication, freedom from maintenance |
|  | Grease Lubrication |
|  | Sealed on both sides |