

**FAG****61840-C3**

Deep groove ball bearing

Deep groove ball bearing 618, single row,  
steel sheet metal cage

## Technical information

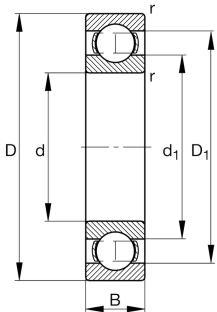

## Your current product variant

Sealing	Without	Not sealed
Cage	JN	Steel sheet metal
Tolerance class	PN	Normal (PN)
Dimensional / heat stabilization	S1	Rings dimensional stabilized up to 200°
Lubricant	Without	Bearing not greased
Radial internal clearance	C3 (Group 3)	Internal clearance larger than CN
Bore type	Z	Cylindrical

## Main Dimensions &amp; Performance Data

d	200 mm	Bore diameter
D	250 mm	Outside diameter
B	24 mm	Width
$C_r$	74.000 N	Basic dynamic load rating, radial
$C_{0r}$	88.000 N	Basic static load rating, radial
$C_{ur}$	3.450 N	Fatigue load limit, radial
$n_G$	3.500 1/min	Limiting speed
$n_{gr}$	2.550 1/min	Reference speed
$m$	2,28 kg	Weight



### Mounting dimensions

$d_{a \min}$	207 mm	Minimum diameter shaft shoulder
$D_{a \max}$	243 mm	Maximum diameter of housing shoulder
$r_{a \max}$	1,5 mm	Maximum fillet radius

### Dimensions

$r_{\min}$	1,5 mm	Minimum chamfer dimension
$D_1$	233,75 mm	Shoulder diameter outer ring
$d_1$	216,74 mm	Shoulder diameter inner ring

### Temperature range

$T_{\min}$	-30 °C	Operating temperature min.
$T_{\max}$	200 °C	Operating temperature max.

### Calculation factors

$f_0$	16	Calculation factor
-------	----	--------------------

### Characteristics

-  Radial load
-  Axial load in one direction
-  Axial load in two directions
-  Grease Lubrication
-  Oil Lubrication
-  Not sealed