**FAG****618/560-M-C3**

Deep groove ball bearing

Deep groove ball bearing 618..-M, single row, solid brass cage

Technical information

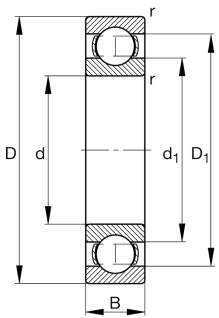

Your current product variant

Sealing	Without	Not sealed
Cage	M	Solid brass cage, rolling element guided
Tolerance class	PN	Normal (ISO 492:2023)
Dimensional / heat stabilization	S1	Rings dimensional stabilized up to 200°
Lubricant	Without	Bearing not greased
Radial internal clearance	C3 (Group 3)	Internal clearance larger than CN
Bore type	Z	Cylindrical

Main Dimensions & Performance Data

d	560 mm	Bore diameter
D	680 mm	Outside diameter
B	56 mm	Width
C_r	310.000 N	Basic dynamic load rating, radial
C_{0r}	560.000 N	Basic static load rating, radial
C_{ur}	13.200 N	Fatigue load limit, radial
n_G	1.540 1/min	Limiting speed
n_{gr}	920 1/min	Reference speed
m	35,1 kg	Weight



Mounting dimensions

$d_{a \min}$	572,4 mm	Minimum diameter shaft shoulder
$D_{a \max}$	667,6 mm	Maximum diameter of housing shoulder
$r_{a \max}$	2,5 mm	Maximum fillet radius

Dimensions

r_{\min}	3 mm	Minimum chamfer dimension
D_1	640,7 mm	Shoulder diameter outer ring
d_1	600,4 mm	Shoulder diameter inner ring





Temperature range

T_{\min}	-30 °C	Operating temperature min.
T_{\max}	200 °C	Operating temperature max.

Calculation factors

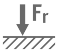
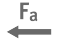
f_0	15,7	Calculation factor
-------	------	--------------------

Characteristics

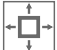
	Radial load
	Axial load in one direction
	Axial load in two directions
	Grease Lubrication
	Oil Lubrication
	Not sealed
	Large bearing