**FAG****61988-MA**

Deep groove ball bearing

Deep groove ball bearing 619..-MA, single row, solid brass cage

Technical information

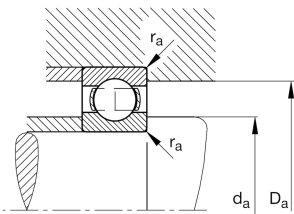
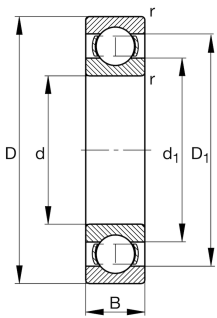

Your current product variant

Sealing	Without	Not sealed
Cage	MA	Solid brass cage, outer ring guided
Tolerance class	PN	Normal (PN)
Dimensional / heat stabilization	S1	Rings dimensional stabilized up to 200°
Lubricant	Without	Bearing not greased
Radial internal clearance	CN (Group N)	Normal internal clearance
Bore type	Z	Cylindrical

Main Dimensions & Performance Data

d	440 mm	Bore diameter
D	600 mm	Outside diameter
B	74 mm	Width
C _r	390.000 N	Basic dynamic load rating, radial
C _{0r}	670.000 N	Basic static load rating, radial
C _{ur}	17.300 N	Fatigue load limit, radial
n _G	1.780 1/min	Limiting speed
n _{gr}	1.250 1/min	Reference speed
m	62,1 kg	Weight



Mounting dimensions

$d_{a \min}$	454,6 mm	Minimum diameter shaft shoulder
$D_{a \max}$	585,4 mm	Maximum diameter of housing shoulder
$r_{a \max}$	3 mm	Maximum fillet radius

Dimensions

r_{\min}	4 mm	Minimum chamfer dimension
D_1	549,9 mm	Shoulder diameter outer ring
d_1	492,85 mm	Shoulder diameter inner ring





Temperature range

T_{\min}	-30 °C	Operating temperature min.
T_{\max}	200 °C	Operating temperature max.

Calculation factors

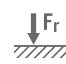
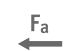
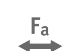
f_0	16,4	Calculation factor
-------	------	--------------------

Characteristics

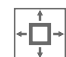
	Radial load
	Axial load in one direction
	Axial load in two directions
	Grease Lubrication
	Oil Lubrication
	Not sealed
	Large bearing