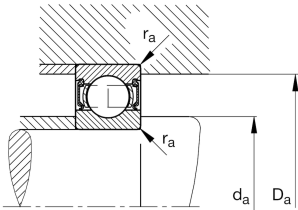
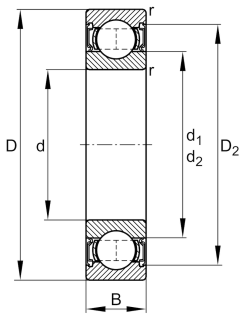

**FAG****6215-2RSR**

Deep groove ball bearing

Deep groove ball bearing 62...-2RSR, single row, seals, steel sheet metal cage

Technical information

**Your current product variant**

Sealing	2RSR	Contact seal on both sides
Cage	JN	Steel sheet metal
Tolerance class	PN	Normal (PN)
Dimensional / heat stabilization	S0	Rings dimensional stabilized up to 150°
Lubricant	GA13	Ball bearing and insert bearing grease
Radial internal clearance	CN (Group N)	Normal internal clearance
Bore type	Z	Cylindrical

Main Dimensions & Performance Data

d	75 mm	Bore diameter
D	130 mm	Outside diameter
B	25 mm	Width
C _r	70.000 N	Basic dynamic load rating, radial
C _{0r}	49.000 N	Basic static load rating, radial
C _{ur}	3.300 N	Fatigue load limit, radial
n _G	2.900 1/min	Limiting speed
m	1,22 kg	Weight

Mounting dimensions

d _{a min}	84 mm	Minimum diameter shaft shoulder
D _{a max}	121 mm	Maximum diameter of housing shoulder
r _{a max}	1,5 mm	Maximum fillet radius



Dimensions

r_{min}	1,5 mm	Minimum chamfer dimension
D_1	113 mm	Shoulder diameter outer ring
D_2	115,5 mm	Caliber diameter outer ring
d_1	92,1 mm	Shoulder diameter inner ring







Temperature range

T_{min}	-20 °C	Operating temperature min.
T_{max}	100 °C	Operating temperature max.

Calculation factors

f_0	14,6	Calculation factor
-------	------	--------------------

Characteristics

-  Radial load
-  Axial load in one direction
-  Axial load in two directions
-  Lifetime lubrication, freedom from maintenance
-  Grease Lubrication
-  Sealed on both sides