

**FAG****6215-RSR**

Deep groove ball bearing

Deep groove ball bearing 62...-RSR, single row, seal, steel sheet metal cage

## Technical information

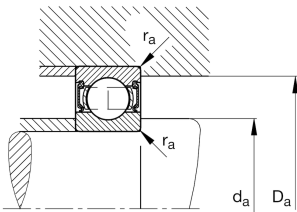
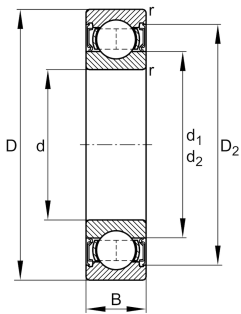

## Your current product variant

Sealing	RSR	Contact seal on one side
Cage	JN	Steel sheet metal
Tolerance class	PN	Normal (ISO 492:2023)
Dimensional / heat stabilization	S0	Rings dimensional stabilized up to 150°
Lubricant	Without	Bearing not greased
Radial internal clearance	CN (Group N)	Normal internal clearance
Bore type	Z	Cylindrical

## Main Dimensions &amp; Performance Data

d	75 mm	Bore diameter
D	130 mm	Outside diameter
B	25 mm	Width
C <sub>r</sub>	70.000 N	Basic dynamic load rating, radial
C <sub>0r</sub>	49.000 N	Basic static load rating, radial
C <sub>ur</sub>	3.300 N	Fatigue load limit, radial
n <sub>G</sub>	2.900 1/min	Limiting speed
m	1,19 kg	Weight

## Mounting dimensions

d <sub>a min</sub>	84 mm	Minimum diameter shaft shoulder
D <sub>a max</sub>	121 mm	Maximum diameter of housing shoulder
r <sub>a max</sub>	1,5 mm	Maximum fillet radius



## Dimensions

$r_{\min}$	1,5 mm	Minimum chamfer dimension
$D_1$	113 mm	Shoulder diameter outer ring
$D_2$	115,5 mm	Caliber diameter outer ring
$d_1$	92,1 mm	Shoulder diameter inner ring

## Temperature range

$T_{\min}$	-30 °C	Operating temperature min.
$T_{\max}$	100 °C	Operating temperature max.

## Calculation factors

$f_0$	14,6	Calculation factor
-------	------	--------------------

## Characteristics



Radial load



Axial load in one direction



Axial load in two directions



Grease Lubrication



Oil Lubrication



Sealed on one side