

**FAG****6009-2RSR-NR-C3**

Deep groove ball bearing



Deep groove ball bearing 60...-2RSR-NR,
single row, seals, ring groove, snap ring, steel
sheet metal cage

Technical information

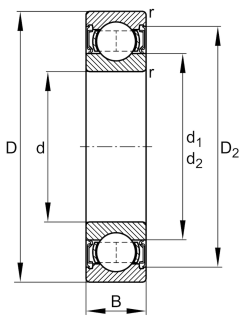

Your current product variant

Sealing	2RSR	Contact seal on both sides
Design, bearing outer ring	NR	Ring groove for snap ring with snap ring
Cage	JN	Steel sheet metal
Tolerance class	PN	Normal (ISO 492:2023)
Dimensional / heat stabilization	SN	Rings dimensional stabilized up to 120°
Lubricant	GA13	Ball bearing and insert bearing grease
Radial internal clearance	C3 (Group 3)	Internal clearance larger than CN
Bore type	Z	Cylindrical

Main Dimensions & Performance Data

d	45 mm	Bore diameter
D	75 mm	Outside diameter
B	16 mm	Width
C_r	21.200 N	Basic dynamic load rating, radial
C_{0r}	14.400 N	Basic static load rating, radial
C_{ur}	750 N	Fatigue load limit, radial
n_G	4.950 1/min	Limiting speed
$\approx m$	0,25 kg	Weight



Mounting dimensions

$d_{a \min}$	49,6 mm	Minimum diameter shaft shoulder
$D_{a \max}$	70,4 mm	Maximum diameter of housing shoulder
$r_{a \max}$	1 mm	Maximum fillet radius

Dimensions

r_{\min}	1 mm	Minimum chamfer dimension
D_1	65,6 mm	Shoulder diameter outer ring
D_2	67,98 mm	Caliber diameter outer ring
d_1	54,2 mm	Shoulder diameter inner ring

Temperature range

T_{\min}	-20 °C	Operating temperature min.
T_{\max}	100 °C	Operating temperature max.

Calculation factors

f_0	15,3	Calculation factor
-------	------	--------------------

Characteristics

	Radial load
	Axial load in one direction
	Axial load in two directions
	Lifetime lubrication, freedom from maintenance
	Grease Lubrication
	Sealed on both sides