

IMAGE
COMING SOON

FAG

6032-N2-M-C4

Deep groove ball bearing

Deep groove ball bearing 60..-N2-M, single row, holding grooves, solid brass cage

Technical information

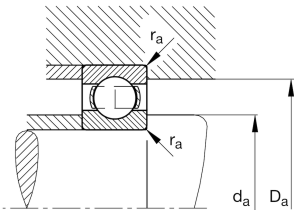
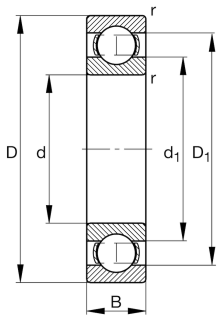

Your current product variant

Sealing	Without	Not sealed
Design, bearing outer ring	N2	Two retaining grooves in the outer ring on one side
Cage	M	Solid brass cage, rolling element guided
Tolerance class	PN	Normal (ISO 492:2023)
Dimensional / heat stabilization	S0	Rings dimensional stabilized up to 150°
Lubricant	Without	Bearing not greased
Radial internal clearance	C4 (Group 4)	Internal clearance larger than C3
Bore type	Z	Cylindrical

Main Dimensions & Performance Data

d	160 mm	Bore diameter
D	240 mm	Outside diameter
B	38 mm	Width
C_r	142.000 N	Basic dynamic load rating, radial
C_{0r}	136.000 N	Basic static load rating, radial
C_{ur}	6.000 N	Fatigue load limit, radial
n_G	4.800 1/min	Limiting speed
n_{gr}	3.750 1/min	Reference speed
$\approx m$	6,14 kg	Weight



Mounting dimensions

$d_{a \min}$	170,2 mm	Minimum diameter shaft shoulder
$D_{a \max}$	229,8 mm	Maximum diameter of housing shoulder
$r_{a \max}$	2,1 mm	Maximum fillet radius

Dimensions

r_{\min}	2,1 mm	Minimum chamfer dimension
D_1	214,64 mm	Shoulder diameter outer ring
d_1	186,2 mm	Shoulder diameter inner ring

Temperature range

T_{\min}	-30 °C	Operating temperature min.
T_{\max}	150 °C	Operating temperature max.

Calculation factors

f_0	16	Calculation factor
-------	----	--------------------

Characteristics

	Radial load
	Axial load in one direction
	Axial load in two directions
	Grease Lubrication
	Oil Lubrication
	Not sealed