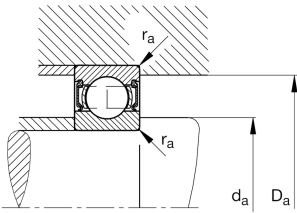

**FAG****6207-2RSR-L207-C3**

Deep groove ball bearing

Deep groove ball bearing 62...-2RSR, single row, seals, steel sheet metal cage

Technical information

**Your current product variant**

Sealing	2RSR	Contact seal on both sides
Cage	JN	Steel sheet metal
Tolerance class	PN	Normal (PN)
Dimensional / heat stabilization	SN	Rings dimensional stabilized up to 120°
Lubricant	L207	Low noise high-temperature grease, interchangeable with grease L069
Radial internal clearance	C3 (Group 3)	Internal clearance larger than CN
Bore type	Z	Cylindrical

Main Dimensions & Performance Data

d	35 mm	Bore diameter
D	72 mm	Outside diameter
B	17 mm	Width
C_r	27.500 N	Basic dynamic load rating, radial
C_{0r}	15.300 N	Basic static load rating, radial
C_{ur}	950 N	Fatigue load limit, radial
n_G	5.700 1/min	Limiting speed
$\approx m$	0,283 kg	Weight

Mounting dimensions

$d_{a \text{ min}}$	42 mm	Minimum diameter shaft shoulder
$D_{a \text{ max}}$	65 mm	Maximum diameter of housing shoulder
$r_{a \text{ max}}$	1 mm	Maximum fillet radius



Dimensions

r_{\min}	1,1 mm	Minimum chamfer dimension
D_1	60,66 mm	Shoulder diameter outer ring
D_2	63,34 mm	Caliber diameter outer ring
d_1	47,2 mm	Shoulder diameter inner ring

Temperature range

T_{\min}	-30 °C	Operating temperature min.
T_{\max}	100 °C	Operating temperature max.

Calculation factors

f_0	13,8	Calculation factor
-------	------	--------------------

Characteristics



Radial load



Axial load in one direction



Axial load in two directions



Lifetime lubrication, freedom from maintenance



Grease Lubrication



Sealed on both sides