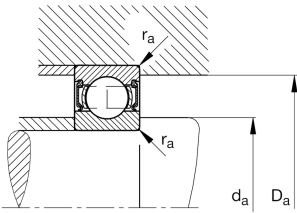

**FAG****6308-2RSR-L207-C3**

Deep groove ball bearing

Deep groove ball bearing 63...2RSR, single row, seals, steel sheet metal cage

## Technical information

**Your current product variant**

Sealing	2RSR	Contact seal on both sides
Cage	JN	Steel sheet metal
Tolerance class	PN	Normal (PN)
Dimensional / heat stabilization	SN	Rings dimensional stabilized up to 120°
Lubricant	L207	Low noise high-temperature grease, interchangeable with grease L069
Radial internal clearance	C3 (Group 3)	Internal clearance larger than CN
Bore type	Z	Cylindrical

**Main Dimensions & Performance Data**

d	40 mm	Bore diameter
D	90 mm	Outside diameter
B	23 mm	Width
$C_r$	45.500 N	Basic dynamic load rating, radial
$C_{0r}$	25.000 N	Basic static load rating, radial
$C_{ur}$	1.690 N	Fatigue load limit, radial
$n_G$	4.800 1/min	Limiting speed
$\approx m$	0,628 kg	Weight

**Mounting dimensions**

$d_{a \text{ min}}$	49 mm	Minimum diameter shaft shoulder
$D_{a \text{ max}}$	81 mm	Maximum diameter of housing shoulder
$r_{a \text{ max}}$	1,5 mm	Maximum fillet radius



### Dimensions

$r_{min}$	1,5 mm	Minimum chamfer dimension
$D_1$	74,64 mm	Shoulder diameter outer ring
$D_2$	76,5 mm	Caliber diameter outer ring
$d_1$	55,55 mm	Shoulder diameter inner ring







### Temperature range

$T_{min}$	-30 °C	Operating temperature min.
$T_{max}$	100 °C	Operating temperature max.

### Calculation factors

$f_0$	13	Calculation factor
-------	----	--------------------

### Characteristics

-   $F_r$  Radial load
-   $F_a$  Axial load in one direction
-   $F_a$  Axial load in two directions
-   $L_h$  Lifetime lubrication, freedom from maintenance
-  Grease Lubrication
-  Sealed on both sides