

**FAG****6215-J20AB-C4**

Deep groove ball bearing

Deep groove ball bearing 62...-J20AB, single row, steel sheet metal cage, ceramic coated

Technical information

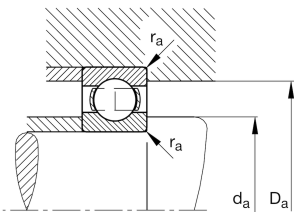
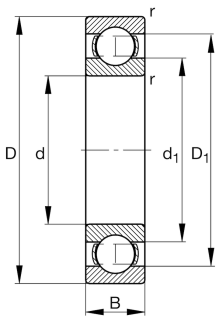

Your current product variant

Sealing	Without	Not sealed
Cage	JN	Steel sheet metal
Tolerance class	PN	Normal (PN)
Dimensional / heat stabilization	S0	Rings dimensional stabilized up to 150°
Lubricant	Without	Bearing not greased
Radial internal clearance	C4 (Group 4)	Internal clearance larger than C3
Bore type	Z	Cylindrical
Coating	J20AB	Current insulation, outer ring ceramic coated

Main Dimensions & Performance Data

d	75 mm	Bore diameter
D	130 mm	Outside diameter
B	25 mm	Width
C_r	70.000 N	Basic dynamic load rating, radial
C_{0r}	49.000 N	Basic static load rating, radial
C_{ur}	3.300 N	Fatigue load limit, radial
n_G	7.800 1/min	Limiting speed
n_{gr}	5.900 1/min	Reference speed
$\approx m$	1,16 kg	Weight



Mounting dimensions

$d_{a \min}$	84 mm	Minimum diameter shaft shoulder
$D_{a \max}$	121 mm	Maximum diameter of housing shoulder
$r_{a \max}$	1,5 mm	Maximum fillet radius

Dimensions

r_{\min}	1,5 mm	Minimum chamfer dimension
D_1	113,3 mm	Shoulder diameter outer ring
d_1	92,1 mm	Shoulder diameter inner ring





Temperature range

T_{\min}	-30 °C	Operating temperature min.
T_{\max}	150 °C	Operating temperature max.

Calculation factors

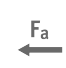
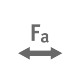
f_0	14,6	Calculation factor
-------	------	--------------------

Characteristics

-  Radial load
-  Axial load in one direction
-  Axial load in two directions
-  Grease Lubrication
-  Oil Lubrication
-  Not sealed
-  Current insulated