**FAG****6212-M-J20AA-C4**

Deep groove ball bearing

Deep groove ball bearing 62...-M-J20AA,
single row, solid brass cage, ceramic coated

Technical information

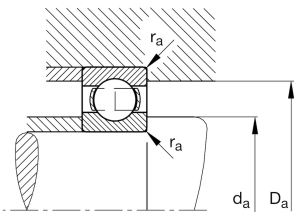
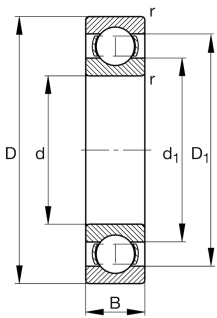

Your current product variant

Sealing	Without	Not sealed
Cage	M	Solid brass cage, rolling element guided
Tolerance class	PN	Normal (PN)
Dimensional / heat stabilization	S0	Rings dimensional stabilized up to 150°
Lubricant	Without	Bearing not greased
Radial internal clearance	C4 (Group 4)	Internal clearance larger than C3
Bore type	Z	Cylindrical
Coating	J20AA	Current insulation, outer ring ceramic coated

Main Dimensions & Performance Data

d	60 mm	Bore diameter
D	110 mm	Outside diameter
B	22 mm	Width
C _r	57.000 N	Basic dynamic load rating, radial
C _{0r}	36.500 N	Basic static load rating, radial
C _{ur}	2.550 N	Fatigue load limit, radial
n _G	12.100 1/min	Limiting speed
n _{gr}	6.800 1/min	Reference speed
≈m	0,92 kg	Weight



Mounting dimensions

$d_{a \min}$	69 mm	Minimum diameter shaft shoulder
$D_{a \max}$	101 mm	Maximum diameter of housing shoulder
$r_{a \max}$	1,5 mm	Maximum fillet radius

Dimensions

r_{\min}	1,5 mm	Minimum chamfer dimension
D_1	96,1 mm	Shoulder diameter outer ring
d_1	75,75 mm	Shoulder diameter inner ring







Temperature range

T_{\min}	-30 °C	Operating temperature min.
T_{\max}	150 °C	Operating temperature max.

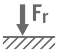
Calculation factors

f_0	14,5	Calculation factor
-------	------	--------------------

Characteristics

	Radial load
	Axial load in one direction
	Axial load in two directions
	Grease Lubrication
	Oil Lubrication
	Not sealed
	Current insulated