

**FAG****4201-BB-TVH-C3**

Deep groove ball bearing

Deep groove ball bearing 42...-BB-TVH,
double row, plastic cage

Technical information

Your current product variant

Design variant	B	Bearing without filling slot
Tolerance class	PN	Normal (PN)
Changed internal design	B	B
Cage	TVH	Solid cage made of glass-fiber reinforced polyamid PA66
Lubricant	GA14	Ball bearing grease, low noise
Dimensional / heat stabilization	SN	Rings dimensional stabilized up to 120°
Radial internal clearance	C3 (Group 3)	Internal clearance larger than CN

Main Dimensions & Performance Data

d	12 mm	Bore diameter
D	32 mm	Outside diameter
B	14 mm	Width
C_r	11.100 N	Basic dynamic load rating, radial
C_{0r}	6.100 N	Basic static load rating, radial
C_{ur}	320 N	Fatigue load limit, radial
n_G	22.300 1/min	Limiting speed
n_{gr}	19.100 1/min	Reference speed
$\approx m$	0,051 kg	Weight

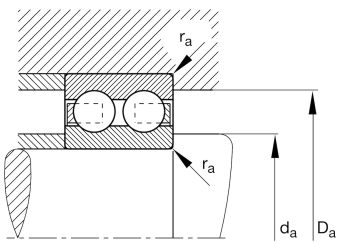
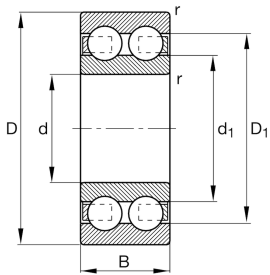



Mounting dimensions

$d_{a \min}$	16,2 mm	Minimum diameter shaft shoulder
$D_{a \max}$	27,8 mm	Maximum diameter of housing shoulder
$r_{a \max}$	0,6 mm	Maximum fillet radius

Dimensions

r_{\min}	0,6 mm	Minimum chamfer dimension
D_1	25,81 mm	Shoulder diameter outer ring
d_1	17,8 mm	Shoulder diameter inner ring

Temperature range

T_{\min}	-20 °C	Operating temperature min.
T_{\max}	120 °C	Operating temperature max.

Calculation factors

f_0	12,3	Calculation factor
-------	------	--------------------

Characteristics



Radial load



Axial load in one direction



Axial load in two directions



Grease Lubrication



Not sealed