

**FAG****4209-BB-TVH** [↗](#)

Deep groove ball bearing

Deep groove ball bearing 42...-BB-TVH,
double row, plastic cage

Technical information

Your current product variant

Design variant	B	Bearing without filling slot
Tolerance class	PN	Normal (PN)
Changed internal design	B	B
Cage	TVH	Solid cage made of glass-fiber reinforced polyamid PA66
Lubricant	GA13	Ball bearing and insert bearing grease
Dimensional / heat stabilization	SN	Rings dimensional stabilized up to 120°
Radial internal clearance	CN (Group N)	Normal internal clearance

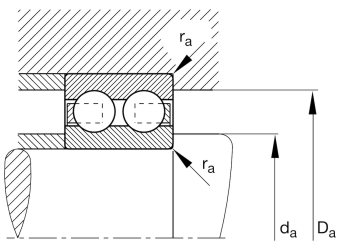
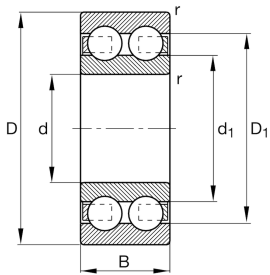

Main Dimensions & Performance Data

d	45 mm	Bore diameter
D	85 mm	Outside diameter
B	23 mm	Width
C_r	44.500 N	Basic dynamic load rating, radial
C_{0r}	38.000 N	Basic static load rating, radial
C_{ur}	1.990 N	Fatigue load limit, radial
n_G	7.900 1/min	Limiting speed
n_{gr}	6.900 1/min	Reference speed
$\approx m$	0.532 kg	Weight



Mounting dimensions

$d_{a \min}$	52 mm	Minimum diameter shaft shoulder
$D_{a \max}$	78 mm	Maximum diameter of housing shoulder
$r_{a \max}$	1 mm	Maximum fillet radius

Dimensions

r_{\min}	1,1 mm	Minimum chamfer dimension
D_1	72,4 mm	Shoulder diameter outer ring
d_1	58,1 mm	Shoulder diameter inner ring

Temperature range

T_{\min}	-20 °C	Operating temperature min.
T_{\max}	120 °C	Operating temperature max.

Calculation factors

f_0	14,9	Calculation factor
-------	------	--------------------

Characteristics



Radial load



Axial load in one direction



Axial load in two directions



Grease Lubrication



Not sealed