

**FAG****4304-BB-TVH** [↗](#)

Deep groove ball bearing

Deep groove ball bearing 43...BB-TVH,
double row, plastic cage

Technical information

Your current product variant

| | | |
|----------------------------------|--------------|---|
| Design variant | B | Bearing without filling slot |
| Tolerance class | PN | Normal (PN) |
| Changed internal design | B | B |
| Cage | TVH | Solid cage made of glass-fiber reinforced polyamid PA66 |
| Lubricant | GA14 | Ball bearing grease, low noise |
| Dimensional / heat stabilization | SN | Rings dimensional stabilized up to 120° |
| Radial internal clearance | CN (Group N) | Normal internal clearance |

Main Dimensions & Performance Data

| | | |
|-------------|--------------|-----------------------------------|
| d | 20 mm | Bore diameter |
| D | 52 mm | Outside diameter |
| B | 21 mm | Width |
| C_r | 26.000 N | Basic dynamic load rating, radial |
| C_{0r} | 16.800 N | Basic static load rating, radial |
| C_{ur} | 870 N | Fatigue load limit, radial |
| n_G | 13.100 1/min | Limiting speed |
| n_{gr} | 9.300 1/min | Reference speed |
| $\approx m$ | 0,212 kg | Weight |

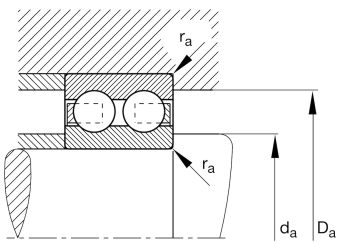
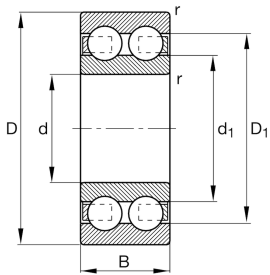



Mounting dimensions

| | | |
|--------------|-------|--------------------------------------|
| $d_{a \min}$ | 27 mm | Minimum diameter shaft shoulder |
| $D_{a \max}$ | 45 mm | Maximum diameter of housing shoulder |
| $r_{a \max}$ | 1 mm | Maximum fillet radius |

Dimensions

| | | |
|------------|----------|------------------------------|
| r_{\min} | 1,1 mm | Minimum chamfer dimension |
| D_1 | 42,45 mm | Shoulder diameter outer ring |
| d_1 | 31,5 mm | Shoulder diameter inner ring |

Temperature range

| | | |
|------------|--------|----------------------------|
| T_{\min} | -20 °C | Operating temperature min. |
| T_{\max} | 120 °C | Operating temperature max. |

Calculation factors

| | | |
|-------|----|--------------------|
| f_0 | 13 | Calculation factor |
|-------|----|--------------------|

Characteristics



Radial load



Axial load in one direction



Axial load in two directions



Grease Lubrication



Not sealed