

**G309-XL-NPP-B**

Self-aligning deep groove ball bearings

Plummer block housing unit G3..-XL-NPP-B,
RIBB sheet metal PB

X-life

Technical information

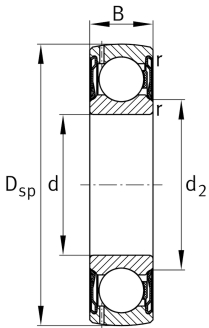
**Your current product variant**

Sealing	NPP	
Shape of outer surface	B	Spherical

Main Dimensions & Performance Data

d	45 mm	Bore diameter
D _{SP}	100 mm	Outside diameter
B	25 mm	Width
C _r	56.000 N	Basic dynamic load rating, radial
C _{0r}	31.500 N	Basic static load rating, radial
≈m	0,84 kg	Weight

Dimensions

C _a	7,6 mm	Distance to lubrication hole
----------------	--------	------------------------------

Temperature range

T _{min}	-20 °C	Operating temperature min.
T _{max}	100 °C	Operating temperature max.