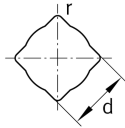
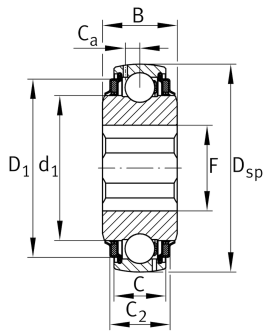

**GVK100-208-KTT-B-AS2/V** [↗](#)

Self-aligning deep groove ball bearings

Plummer block housing unit GVK...-208-KTT-B-AS2/V, RIBB sheet metal PB

Technical information

**Your current product variant**

Type of Sealing	KTT	Triple lip seals on both sides
Shape of outer surface	B	Spherical
Deviating ballset	208	208
Deviating feature	AS2/V	AS2/V

Main Dimensions & Performance Data

D _{SP}	80 mm	Outside diameter
B	36,5 mm	Width
C _r	32.500 N	Basic dynamic load rating, radial
C _{0r}	19.800 N	Basic static load rating, radial
≈m	0,697 kg	Weight



Dimensions

D ₁	68,3 mm	Outside diameter seal
C	21 mm	Width, outer ring
F	35,4 mm	Maximum distance hexagonal bore
r	2,5 mm	Radius hexagonal bore
C ₂	28,1 mm	Sealing total width
d ₁	52,3 mm	Rib diameter inner ring
d	25,4 mm	Width of flats
C _a	6,4 mm	Distance to lubrication hole
	0,9 mm	Width across flats upper tolerance
d	25,4 mm	Width across flats (Inch)
	0,6 mm	Width across flats lower tolerance





Temperature range

T _{min}	-20 °C	Operating temperature min.
T _{max}	100 °C	Operating temperature max.

Calculation factors

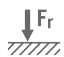
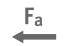
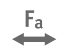
f ₀	13,6	Calculation factor
----------------	------	--------------------

Characteristics

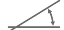
	Radial load
	Axial load in one direction
	Axial load in two directions
	Lifetime lubrication, freedom from maintenance
	Grease Lubrication
	Sealed on both sides
	Static angular error and misalignment