



RAE25-XL-NPP-NR

Radial insert ball bearing

Radial insert ball bearings RAE..-NPP-NR, cylindrical outer ring, location by eccentric locking collar, slots in outer ring, P seals on both sides

X-life

Technical information

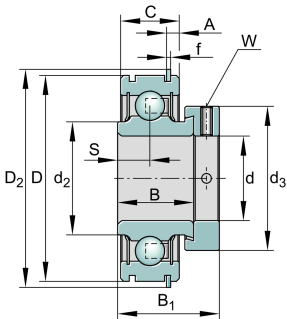

Main Dimensions & Performance Data

| | | |
|-----------------|----------|-----------------------------------|
| d | 25 mm | Bore diameter |
| D | 52 mm | Outside diameter |
| B | 21,4 mm | Width |
| B ₁ | 31 mm | Locking collar total width |
| C _r | 14.000 N | Basic dynamic load rating, radial |
| C _{0r} | 7.800 N | Basic static load rating, radial |
| C _{ur} | 410 N | Fatigue load limit, radial |
| ≈m | 0,2 kg | Weight |



Dimensions

| | | |
|----------------|----------|---|
| C | 15 mm | Width, outer ring |
| S | 7,5 mm | Distance raceway |
| d ₂ | 30,5 mm | Rib diameter sealing inner ring |
| d ₃ | 37,5 mm | Outside diameter locking collar/locknut |
| A | 3,58 mm | Distance snap ring |
| | 0 mm | Upper distance retaining ring tolerance |
| | -0,25 mm | Lower distance retaining ring tolerance |
| W | 3 mm | Width of flats |
| D ₂ | 57,9 mm | Outside diameter snap ring |
| | 0 mm | Upper width snap ring tolerance |
| | -0,1 mm | Lower width snap ring tolerance |

Calculation factors

| | | |
|----------------|------|--------------------|
| f ₀ | 13,8 | Calculation factor |
|----------------|------|--------------------|