

RAE35-XL-NPP-NR

Radial insert ball bearing

Radial insert ball bearings RAE..-NPP-NR, cylindrical outer ring, location by eccentric locking collar, slots in outer ring, P seals on both sides

X-life

Technical information

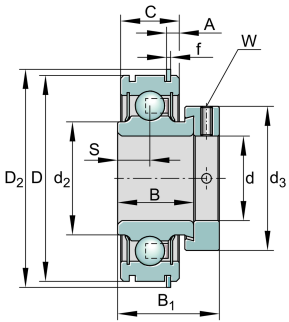

Main Dimensions & Performance Data

d	35 mm	Bore diameter
D	72 mm	Outside diameter
B	25,4 mm	Width
B ₁	39 mm	Locking collar total width
C _r	25.500 N	Basic dynamic load rating, radial
C _{0r}	15.300 N	Basic static load rating, radial
C _{ur}	730 N	Fatigue load limit, radial
≈m	0,53 kg	Weight



Dimensions

C	19 mm	Width, outer ring
S	9,5 mm	Distance raceway
d ₂	44,6 mm	Rib diameter sealing inner ring
d ₃	55 mm	Outside diameter locking collar/locknut
A	4,98 mm	Distance snap ring
	0 mm	Upper distance retaining ring tolerance
	-0,3 mm	Lower distance retaining ring tolerance
W	5 mm	Width of flats
D ₂	78,6 mm	Outside diameter snap ring
	0 mm	Upper width snap ring tolerance
	-0,1 mm	Lower width snap ring tolerance

Calculation factors

f ₀	13,8	Calculation factor
----------------	------	--------------------