

**AY20-XL-NPP-B**

Radial insert ball bearing

Radial insert ball bearings AY..-NPP-B,  
spherical outer ring, location by grub screws,  
P seals on both sides

X-life

## Technical information

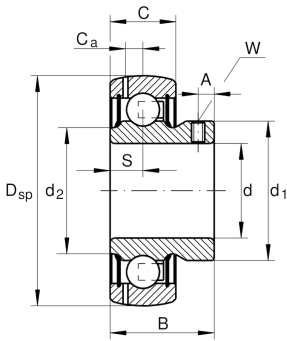
**Main Dimensions & Performance Data**

d	20 mm	Bore diameter
D <sub>SP</sub>	47 mm	Outside diameter
B	25 mm	Width
C <sub>0r</sub>	6.600 N	Basic static load rating, radial
C <sub>ur</sub>	345 N	Fatigue load limit, radial
C <sub>r</sub>	13.600 N	Basic dynamic load rating, radial
≈m	0,13 kg	Weight

**Dimensions**

C	14 mm	Width, outer ring
S	7 mm	Distance raceway
d <sub>1</sub>	28,3 mm	Rib diameter inner ring
d <sub>2</sub>	26,7 mm	Rib diameter sealing inner ring
A	4,5 mm	Distance thread
W	2,5 mm	Width of flats

**Calculation factors**

f <sub>0</sub>	13,1	Calculation factor
----------------	------	--------------------



### Characteristics

---

-  Radial load
-  Axial load in one direction
-  Axial load in two directions
-  Lifetime lubrication, freedom from maintenance
-  Grease Lubrication
-  Sealed on both sides
-  Static angular error and misalignment