

**GAY60-XL-NPP-B**

## Radial insert ball bearing

Radial insert ball bearings GAY..-NPP-B,  
spherical outer ring, location by grub screws,  
P seals on both sides

X-life

## Technical information

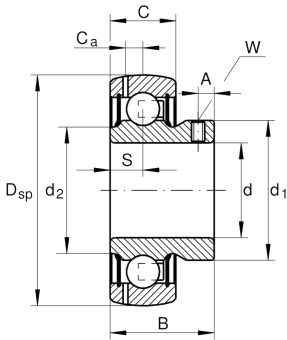
**Main Dimensions & Performance Data**

d	60 mm	Bore diameter
D <sub>SP</sub>	110 mm	Outside diameter
B	47 mm	Width
C <sub>0r</sub>	36.000 N	Basic static load rating, radial
C <sub>ur</sub>	1.530 N	Fatigue load limit, radial
C <sub>r</sub>	52.000 N	Basic dynamic load rating, radial
≈m	1,109 kg	Weight

**Dimensions**

C	24 mm	Width, outer ring
S	13 mm	Distance raceway
d <sub>1</sub>	76 mm	Rib diameter inner ring
d <sub>2</sub>	73,6 mm	Rib diameter sealing inner ring
C <sub>a</sub>	7,2 mm	Distance to lubrication hole
A	10 mm	Distance thread
W	5 mm	Width of flats

**Temperature range**

T <sub>min</sub>	-20 °C	Operating temperature min.
T <sub>max</sub>	120 °C	Operating temperature max.



### Calculation factors

---

$f_0$	14,3	Calculation factor
-------	------	--------------------

### Characteristics

---

-  Radial load
-  Axial load in one direction
-  Axial load in two directions
-  Lifetime lubrication, freedom from maintenance
-  Grease Lubrication
-  Sealed on both sides
-  Static angular error and misalignment