

**GRAE50-XL-NPP-B**

Radial insert ball bearing

Radial insert ball bearing GRAE...XL-NPP-B

X-life

## Technical information

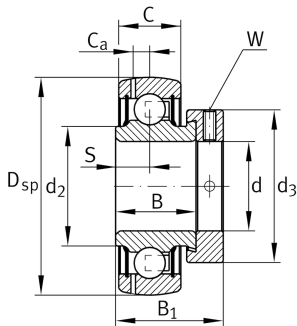
**Main Dimensions & Performance Data**

d	50 mm	Bore diameter
D <sub>SP</sub>	90 mm	Outside diameter
B	30,2 mm	Width
C <sub>0r</sub>	23.200 N	Basic static load rating, radial
C <sub>ur</sub>	1.210 N	Fatigue load limit, radial
B <sub>1</sub>	43,8 mm	Locking collar total width
C <sub>r</sub>	37.500 N	Basic dynamic load rating, radial
≈m	0,729 kg	Weight

**Dimensions**

C	22 mm	Width, outer ring
S	11 mm	Distance raceway
d <sub>2</sub>	59,4 mm	Rib diameter sealing inner ring
C <sub>a</sub>	6,9 mm	Distance to lubrication hole
d <sub>3</sub>	69 mm	Outside diameter locking collar/locknut
W	5 mm	Width of flats

**Calculation factors**

f <sub>0</sub>	14,4	Calculation factor
----------------	------	--------------------



### Characteristics

---

-  Radial load
-  Axial load in one direction
-  Axial load in two directions
-  Lifetime lubrication, freedom from maintenance
-  Grease Lubrication
-  Sealed on both sides
-  Static angular error and misalignment