

**GYE45-210-XL-KRR-B**

Radial insert ball bearing

Radial insert ball bearings GYE...-KRR-B,  
spherical outer ring, location by grub screws,  
R seals on both sides

X-life

## Technical information

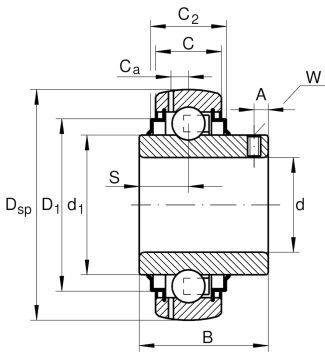
**Main Dimensions & Performance Data**

d	45 mm	Bore diameter
D <sub>SP</sub>	90 mm	Outside diameter
B	51,6 mm	Width
C <sub>0r</sub>	23.200 N	Basic static load rating, radial
C <sub>ur</sub>	1.210 N	Fatigue load limit, radial
C <sub>r</sub>	37.500 N	Basic dynamic load rating, radial
≈m	0,914 kg	Weight

**Dimensions**

C	22 mm	Width, outer ring
C <sub>2</sub>	26,4 mm	Sealing total width
S	19 mm	Distance raceway
d <sub>1</sub>	62,9 mm	Rib diameter inner ring
D <sub>1</sub>	77,3 mm	Outside diameter seal
C <sub>a</sub>	6,9 mm	Distance to lubrication hole
A	8,5 mm	Distance thread
W	4 mm	Width of flats

**Calculation factors**

f <sub>0</sub>	14,4	Calculation factor
----------------	------	--------------------



## Characteristics

---



Radial load



Axial load in one direction



Axial load in two directions



Lifetime lubrication, freedom from maintenance



Grease Lubrication



Sealed on both sides



Static angular error and misalignment