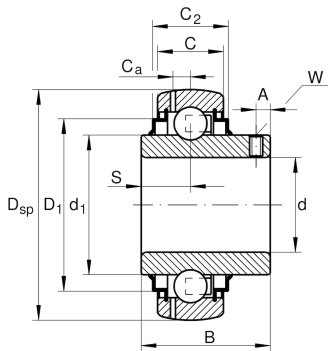

**GYE70-KTT-B-L114**

Radial insert ball bearing

Radial insert ball bearing GYE...KTT-B

## Technical information

**Your current product variant**

Lubricant	L114	Grease (L114)
-----------	------	---------------

**Main Dimensions & Performance Data**

d	70 mm	Bore diameter
D SP	125 mm	Outside diameter
B	74,6 mm	Width
C <sub>0r</sub>	44.000 N	Basic static load rating, radial
C <sub>ur</sub>	2.020 N	Fatigue load limit, radial
C <sub>r</sub>	62.000 N	Basic dynamic load rating, radial
≈m	1,97 kg	Weight

**Dimensions**

C	28 mm	Width, outer ring
C <sub>2</sub>	32 mm	Sealing total width
S	30,2 mm	Distance raceway
d <sub>1</sub>	85,2 mm	Rib diameter inner ring
D <sub>1</sub>	109 mm	Outside diameter seal
C <sub>a</sub>	8,9 mm	Distance to lubrication hole
A	12 mm	Distance thread
W	5 mm	Width of flats









### Temperature range

$T_{min}$	-20 °C	Operating temperature min.
$T_{max}$	100 °C	Operating temperature max.

### Calculation factors

$f_0$	14,4	Calculation factor
-------	------	--------------------

### Characteristics

-   $F_r$  Radial load
-   $F_a$  Axial load in one direction
-   $F_a$  Axial load in two directions
-   $L_h$  Lifetime lubrication, freedom from maintenance
-  Grease Lubrication
-  Sealed on both sides
-  Static angular error and misalignment