

**GYE12-XL-KRR-B**

Radial insert ball bearing

Radial insert ball bearings GYE...-KRR-B,
spherical outer ring, location by grub screws,
R seals on both sides

X-life

Technical information

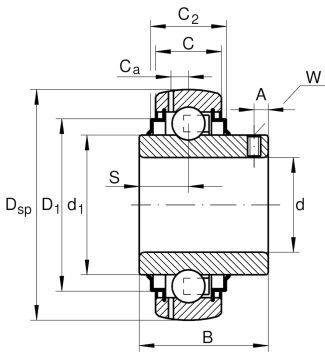
**Main Dimensions & Performance Data**

| | | |
|-----------------|---------|-----------------------------------|
| d | 12 mm | Bore diameter |
| D _{SP} | 40 mm | Outside diameter |
| B | 27,4 mm | Width |
| C _{0r} | 4.750 N | Basic static load rating, radial |
| C _{ur} | 202 N | Fatigue load limit, radial |
| C _r | 9.800 N | Basic dynamic load rating, radial |
| ≈m | 0,11 kg | Weight |

Dimensions

| | | |
|----------------|---------|------------------------------|
| C | 12 mm | Width, outer ring |
| C ₂ | 16,6 mm | Sealing total width |
| S | 11,5 mm | Distance raceway |
| d ₁ | 23,9 mm | Rib diameter inner ring |
| D ₁ | 31,6 mm | Outside diameter seal |
| C _a | 3,4 mm | Distance to lubrication hole |
| A | 4 mm | Distance thread |
| W | 2,5 mm | Width of flats |

Calculation factors

| | | |
|----------------|----|--------------------|
| f ₀ | 13 | Calculation factor |
|----------------|----|--------------------|



Characteristics

-  Radial load
-  Axial load in one direction
-  Axial load in two directions
-  Lifetime lubrication, freedom from maintenance
-  Grease Lubrication
-  Sealed on both sides
-  Static angular error and misalignment