

**GYE25-XL-KRR-B**

Radial insert ball bearing

Radial insert ball bearings GYE...-KRR-B,  
spherical outer ring, location by grub screws,  
R seals on both sides

X-life

## Technical information

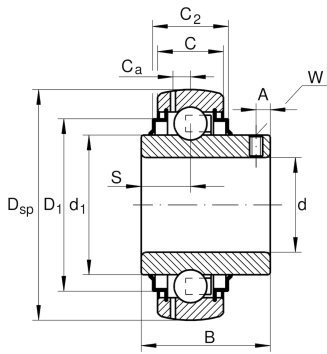
**Main Dimensions & Performance Data**

d	25 mm	Bore diameter
D <sub>SP</sub>	52 mm	Outside diameter
B	34,1 mm	Width
C <sub>0r</sub>	7.800 N	Basic static load rating, radial
C <sub>ur</sub>	335 N	Fatigue load limit, radial
C <sub>r</sub>	14.000 N	Basic dynamic load rating, radial
≈m	0,19 kg	Weight

**Dimensions**

C	15 mm	Width, outer ring
C <sub>2</sub>	16,7 mm	Sealing total width
S	14,3 mm	Distance raceway
d <sub>1</sub>	33,8 mm	Rib diameter inner ring
D <sub>1</sub>	42,5 mm	Outside diameter seal
C <sub>a</sub>	3,9 mm	Distance to lubrication hole
A	5 mm	Distance thread
W	2,5 mm	Width of flats

**Calculation factors**

f <sub>0</sub>	13,8	Calculation factor
----------------	------	--------------------



### Characteristics

---

-  Radial load
-  Axial load in one direction
-  Axial load in two directions
-  Lifetime lubrication, freedom from maintenance
-  Grease Lubrication
-  Sealed on both sides
-  Static angular error and misalignment