

**GYE40-XL-KRR-B**

Radial insert ball bearing

Radial insert ball bearings GYE...-KRR-B,
spherical outer ring, location by grub screws,
R seals on both sides

X-life

Technical information

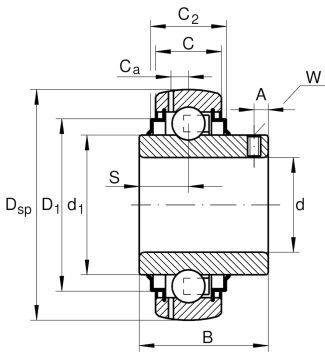
**Main Dimensions & Performance Data**

d	40 mm	Bore diameter
D _{SP}	80 mm	Outside diameter
B	49,2 mm	Width
C _{0r}	19.800 N	Basic static load rating, radial
C _{ur}	840 N	Fatigue load limit, radial
C _r	32.500 N	Basic dynamic load rating, radial
≈m	0,61 kg	Weight

Dimensions

C	21 mm	Width, outer ring
C ₂	23,5 mm	Sealing total width
S	19 mm	Distance raceway
d ₁	52,3 mm	Rib diameter inner ring
D ₁	68,3 mm	Outside diameter seal
C _a	6,4 mm	Distance to lubrication hole
A	8 mm	Distance thread
W	4 mm	Width of flats

Calculation factors

f ₀	13,6	Calculation factor
----------------	------	--------------------



Characteristics



Radial load



Axial load in one direction



Axial load in two directions



Lifetime lubrication, freedom from maintenance



Grease Lubrication



Sealed on both sides



Static angular error and misalignment