

**GYE70-XL-KRR-B**

Radial insert ball bearing

Radial insert ball bearings GYE...-KRR-B,  
spherical outer ring, location by grub screws,  
R seals on both sides

X-life

## Technical information

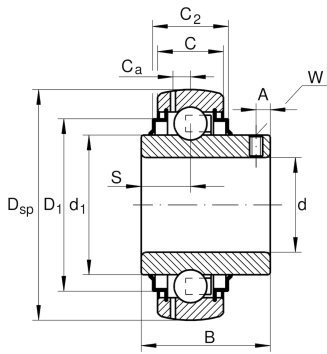
**Main Dimensions & Performance Data**

|                 |          |                                   |
|-----------------|----------|-----------------------------------|
| d               | 70 mm    | Bore diameter                     |
| D <sub>SP</sub> | 125 mm   | Outside diameter                  |
| B               | 74,6 mm  | Width                             |
| C <sub>0r</sub> | 44.000 N | Basic static load rating, radial  |
| C <sub>ur</sub> | 2.020 N  | Fatigue load limit, radial        |
| C <sub>r</sub>  | 62.000 N | Basic dynamic load rating, radial |
| ≈m              | 1,83 kg  | Weight                            |

**Dimensions**

|                |         |                              |
|----------------|---------|------------------------------|
| C              | 28 mm   | Width, outer ring            |
| C <sub>2</sub> | 32,5 mm | Sealing total width          |
| S              | 30,2 mm | Distance raceway             |
| d <sub>1</sub> | 85,2 mm | Rib diameter inner ring      |
| D <sub>1</sub> | 109 mm  | Outside diameter seal        |
| C <sub>a</sub> | 8,9 mm  | Distance to lubrication hole |
| A              | 12 mm   | Distance thread              |
| W              | 5 mm    | Width of flats               |

**Calculation factors**

|                |      |                    |
|----------------|------|--------------------|
| f <sub>0</sub> | 14,4 | Calculation factor |
|----------------|------|--------------------|



## Characteristics

---

-  Radial load
-  Axial load in one direction
-  Axial load in two directions
-  Lifetime lubrication, freedom from maintenance
-  Grease Lubrication
-  Sealed on both sides
-  Static angular error and misalignment