

**GYE90-XL-KRR-B**

Radial insert ball bearing

Radial insert ball bearings GYE...-KRR-B,
spherical outer ring, location by grub screws,
R seals on both sides

X-life

Technical information

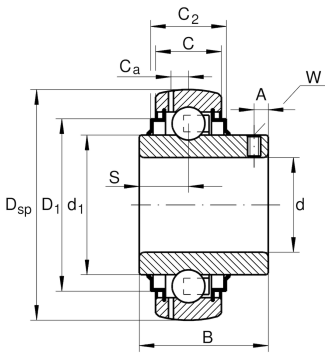
**Main Dimensions & Performance Data**

d	90 mm	Bore diameter
D _{SP}	160 mm	Outside diameter
B	96 mm	Width
C _{0r}	72.000 N	Basic static load rating, radial
C _{ur}	2.700 N	Fatigue load limit, radial
C _r	106.000 N	Basic dynamic load rating, radial
≈m	3,73 kg	Weight

Dimensions







C	32 mm	Width, outer ring
C ₂	35,5 mm	Sealing total width
S	39,7 mm	Distance raceway
d ₁	109,4 mm	Rib diameter inner ring
D ₁	138 mm	Outside diameter seal
C _a	10 mm	Distance to lubrication hole
A	12 mm	Distance thread
W	6 mm	Width of flats

Calculation factors

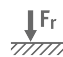
f ₀	14,6	Calculation factor
----------------	------	--------------------

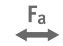

Characteristics

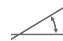
-  Radial load
-  Axial load in one direction
-  Axial load in two directions
-  Lifetime lubrication, freedom from maintenance
-  Grease Lubrication
-  Sealed on both sides
-  Static angular error and misalignment