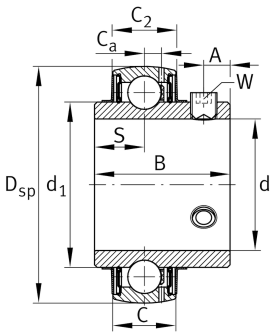

**FAG****UC210-30**

Radial insert ball bearing

Radial insert ball bearings UC, spherical outer ring, location by grub screws, RSR seals on both sides

Technical information

**Main Dimensions & Performance Data**

d	47,625 mm	Bore diameter
d	47,625 mm	Bore diameter, inch
D _{SP}	90 mm	Outside diameter
B	51,6 mm	Width
C _{0r}	23.200 N	Basic static load rating, radial
C _{ur}	1.210 N	Fatigue load limit, radial
C _r	37.500 N	Basic dynamic load rating, radial
≈m	0,837 kg	Weight

Dimensions

C	24 mm	Width, outer ring
C ₂	24,6 mm	Sealing total width
S	19 mm	Distance raceway
d ₁	62,84 mm	Rib diameter inner ring
C _a	6,5 mm	Distance to lubrication hole
A	10 mm	Distance thread

Temperature range

T _{min}	-20 °C	Operating temperature min.
T _{max}	100 °C	Operating temperature max.



Calculation factors

f_0	14,4	Calculation factor
-------	------	--------------------

Characteristics

-  Radial load
-  Axial load in one direction
-  Axial load in two directions
-  Lifetime lubrication, freedom from maintenance
-  Grease Lubrication
-  Sealed on both sides
-  Static angular error and misalignment