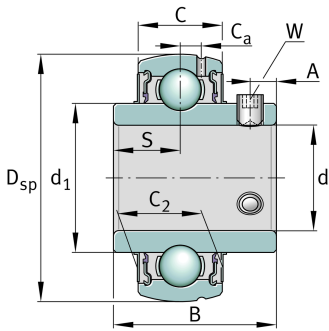

**GYE35-KRR-B-FA107-VA-HLA** [↗](#)

Radial insert ball bearing

Radial insert ball bearing GYE...KRR-B-FA107-VA

Technical information

**Main Dimensions & Performance Data**

d	35 mm	Bore diameter
D _{SP}	72 mm	Outside diameter
B	42,9 mm	Width
C _{0r}	15.300 N	Basic static load rating, radial
C _r	25.500 N	Basic dynamic load rating, radial
≈m	0,46 kg	Weight

Dimensions

C	20 mm	Width, outer ring
C ₂	20,6 mm	Sealing total width
S	17,5 mm	Distance raceway
d ₁	47,4 mm	Rib diameter inner ring
C _a	5,6 mm	Distance to lubrication hole
A	6,5 mm	Distance thread
W	3 mm	Width of flats



Characteristics

-  Radial load
-  Axial load in one direction
-  Axial load in two directions
-  Lifetime lubrication, freedom from maintenance
-  Grease Lubrication
-  Sealed on both sides
-  Protected against rust
-  Static angular error and misalignment