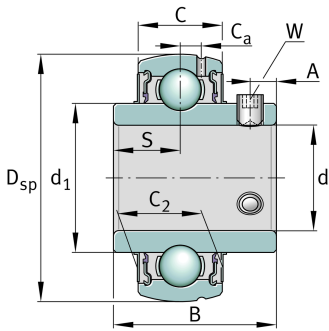

**GYE40-KRR-B-FA107-VA-HLA** [↗](#)

Radial insert ball bearing

Radial insert ball bearing GYE...KRR-B-FA107-VA

## Technical information

**Main Dimensions & Performance Data**

d	40 mm	Bore diameter
D <sub>SP</sub>	80 mm	Outside diameter
B	49,2 mm	Width
C <sub>0r</sub>	18.100 N	Basic static load rating, radial
C <sub>r</sub>	29.500 N	Basic dynamic load rating, radial
m	0,608 kg	Weight

**Dimensions**

C	21 mm	Width, outer ring
C <sub>2</sub>	21,6 mm	Sealing total width
S	19 mm	Distance raceway
d <sub>1</sub>	52,83 mm	Rib diameter inner ring
C <sub>a</sub>	5,9 mm	Distance to lubrication hole
A	8 mm	Distance thread
W	4 mm	Width of flats



### Characteristics

---

-  Radial load
-  Axial load in one direction
-  Axial load in two directions
-  Lifetime lubrication, freedom from maintenance
-  Grease Lubrication
-  Sealed on both sides
-  Protected against rust
-  Static angular error and misalignment