

**FAG****HCB71922-C-T-P4S-UL**

## Spindle bearing

Spindle bearing HCB719.-C, adjusted, in pairs or sets, contact angle  $\alpha = 15^\circ$ , with ceramic balls, restricted tolerances

## Technical information

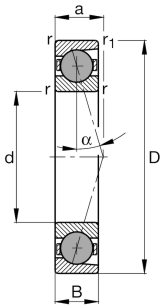

## Your current product variant

Contact angle	C	Contact angle $15^\circ$
Type of seal	Without	Not sealed
Cage	T	Laminated fabric cage
Tolerance class	P4S	Tolerance class P4S, FAG standard better than P4 to DIN 620
Arrangement bearing set	U	Single bearing
Preload	L	Preload light

## Main Dimensions &amp; Performance Data

d	110 mm	Bore diameter
D	150 mm	Outside diameter
B	20 mm	Width
$C_r$	61.000 N	Basic dynamic load rating, radial
$C_{0r}$	45.000 N	Basic static load rating, radial
$C_{ur}$	3.200 N	Fatigue load limit, radial
$n_G$ Grease	12.000 1/min	Limiting speed for grease lubrication
$n_G$ Oil	19.000 1/min	Limiting speed for oil lubrication
$\approx m$	0,719 kg	Weight





### Mounting dimensions

$d_a$	117 mm	Diameter shaft shoulder
$d_a$	h12	Diameter shaft shoulder clearance
$D_a$	143 mm	Shoulder diameter outer ring
$D_a$	H12	Shoulder diameter outer ring clearance
$r_{a \max}$	0,6 mm	Maximum recess radius
$r_{a1 \max}$	0,6 mm	Maximum recess radius
$E_{tk \min}$	122,4 mm	Minimum diameter injection pitch
$E_{tk \max}$	126,4 mm	Maximum diameter injection pitch
$E_{tk1 \min}$	122,4 mm	Minimum diameter injection pitch
$E_{tk1 \max}$	126,4 mm	Maximum diameter injection pitch
$a$	27,4 mm	Distance between the apexes of the pressure cones

### Dimensions

$r_{\min}$	1,1 mm	Minimum chamfer dimension
$r_{1 \min}$	1,1 mm	Minimum chamfer dimension
$\alpha$	15 °	Contact angle

### Temperature range

$T_{\min}$	-30 °C	Operating temperature min.
$T_{\max}$	100 °C	Operating temperature max.



### Additional information

$F_{VL}$	158 N	Preload force light
$F_{VM}$	570 N	Preload force medium
$F_{VH}$	1.199 N	Preload force heavy
$K_{aEL}$	468 N	Lift-off force light
$K_{aEM}$	1.777 N	Lift-off force medium
$K_{aEH}$	3.931 N	Lift-off force heavy
$c_{aL}$	82 N/ $\mu$ m	Axial rigidity light
$c_{aM}$	138 N/ $\mu$ m	Axial rigidity medium
$c_{aH}$	193 N/ $\mu$ m	Axial rigidity heavy

### Characteristics

-  Radial load
-  Axial load in one direction
-  Grease Lubrication
-  Oil Lubrication
-  Not sealed