

**FAG****HSS7021-E-T-P4S-UL**

High speed spindle bearing

High speed spindle bearing HSS70...-E, adjusted, in pairs or sets, contact angle $\alpha = 25^\circ$, lip seals on both sides, non-contact, restricted tolerances

Technical information

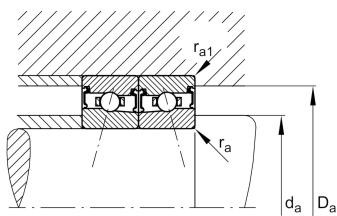
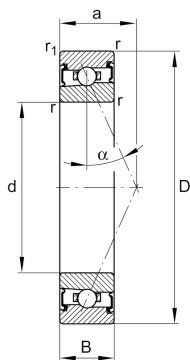

Your current product variant

Contact angle	E	Contact angle 25°
Type of Seal	2RSD	Non-contact sealed on both sides and greased "for life"
Cage	T	Laminated fabric cage
Tolerance class	P4S	Tolerance class P4S, FAG standard better than P4 to ISO 492:2023
Arrangement bearing set	U	Single bearing
Preload class	L	Preload light
Lubricant	GA21	Grease for super precision bearings, standard

Main Dimensions & Performance Data

d	105 mm	Bore diameter
D	160 mm	Outside diameter
B	26 mm	Width
C _r	45.000 N	Basic dynamic load rating, radial
C _{0r}	34.500 N	Basic static load rating, radial
C _{ur}	3.150 N	Fatigue load limit, radial
n _G Grease	11.000 1/min	Limiting speed for grease lubrication
n _G	16.000 1/min	Limiting speed
≈m	1,632 kg	Weight



Mounting dimensions

d_a	116 mm	Diameter shaft shoulder
d_a	H12	Diameter shaft shoulder clearance
D_a	150 mm	Shoulder diameter outer ring
D_a	H12	Shoulder diameter outer ring clearance
$r_{a \max}$	2 mm	Maximum recess radius
$r_{a1 \max}$	1 mm	Maximum recess radius
a	43,9 mm	Distance between the apexes of the pressure cones

Dimensions

r_{\min}	2 mm	Minimum chamfer dimension
$r_{1 \min}$	2 mm	Minimum chamfer dimension
α	25 °	Contact angle

Temperature range

T_{\min}	-30 °C	Operating temperature min.
T_{\max}	80 °C	Operating temperature max.

Additional information

F_{VL}	267 N	Preload force light
F_{VM}	802 N	Preload force medium
F_{VH}	1.604 N	Preload force heavy
K_{aEL}	770 N	Lift-off force light
K_{aEM}	2.354 N	Lift-off force medium
K_{aEH}	4.797 N	Lift-off force heavy
c_{aL}	189 N/ μ m	Axial rigidity light
c_{aM}	281 N/ μ m	Axial rigidity medium
c_{aH}	365 N/ μ m	Axial rigidity heavy



Characteristics



Radial load



Axial load in one direction



Lifetime lubrication, freedom from maintenance



Grease Lubrication



Sealed on both sides