**FAG****HCM7010-C-T-P4S-UL-XL**

High speed spindle bearing

High speed spindle bearing HCM70..-C, adjusted, in pairs or sets, contact angle $\alpha = 17^\circ$, with ceramic balls, restricted tolerances

Technical information

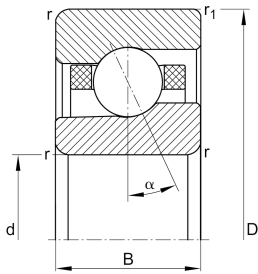

Your current product variant

| | | |
|-------------------------|-------------------|---|
| Contact angle | Contact angle 17° | Contact angle 17° |
| Sealing | Without | Not sealed |
| Cage | T | Laminated fabric cage |
| Tolerance class | P4S | Tolerance class P4S, FAG standard better than P4 to DIN 620 |
| Arrangement bearing set | U | Single bearing |
| Preload | L | Preload light |

Main Dimensions & Performance Data

| | | |
|-----------------|--------------|---------------------------------------|
| d | 50 mm | Bore diameter |
| D | 80 mm | Outside diameter |
| B | 16 mm | Width |
| C_r | 13.100 N | Basic dynamic load rating, radial |
| C_{0r} | 7.100 N | Basic static load rating, radial |
| C_{ur} | 570 N | Fatigue load limit, radial |
| n_G Grease | 32.000 1/min | Limiting speed for grease lubrication |
| n_G Oil | 45.000 1/min | Limiting speed for oil lubrication |
| $\approx m$ | 256,56 g | Weight |



Mounting dimensions

| | | |
|----------------|---------|---|
| d_a | 56 mm | Diameter shaft shoulder |
| d_a | h12 | Diameter shaft shoulder clearance |
| D_a | 74 mm | Shoulder diameter outer ring |
| D_a | H12 | Shoulder diameter outer ring clearance |
| $r_{a \max}$ | 1 mm | Maximum recess radius |
| $r_{a1 \max}$ | 0,3 mm | Maximum recess radius |
| $E_{tk \min}$ | 61,2 mm | Minimum diameter injection pitch |
| $E_{tk \max}$ | 63 mm | Maximum diameter injection pitch |
| $E_{tk1 \min}$ | 58,8 mm | Minimum diameter injection pitch |
| $E_{tk1 \max}$ | 63 mm | Maximum diameter injection pitch |
| a | 17,9 mm | Distance between the apexes of the pressure cones |

Dimensions

| | | |
|--------------|--------|---------------------------|
| r_{\min} | 1 mm | Minimum chamfer dimension |
| $r_{1 \min}$ | 0,6 mm | Minimum chamfer dimension |
| α | 17 ° | Contact angle |

Temperature range

| | | |
|------------|--------|----------------------------|
| T_{\min} | -30 °C | Operating temperature min. |
| T_{\max} | 100 °C | Operating temperature max. |



Additional information

| | | |
|-----------|---------------|-----------------------|
| F_{VL} | 55 N | Preload force light |
| F_{VM} | 144 N | Preload force medium |
| F_{VH} | 303 N | Preload force heavy |
| K_{aEL} | 159 N | Lift-off force light |
| K_{aEM} | 430 N | Lift-off force medium |
| K_{aEH} | 928 N | Lift-off force heavy |
| c_{aL} | 45 N/ μ m | Axial rigidity light |
| c_{aM} | 65 N/ μ m | Axial rigidity medium |
| c_{aH} | 88 N/ μ m | Axial rigidity heavy |

Characteristics

-  Radial load
-  Axial load in one direction
-  Grease Lubrication
-  Oil Lubrication
-  Not sealed