



FAG

**HCM7013-E-T-P4S-UL-XL**

## High speed spindle bearing

High speed spindle bearing HCM70..-E, adjusted, in pairs or sets, contact angle  $\alpha = 25^\circ$ , with ceramic balls, restricted tolerances

X-life

## Technical information

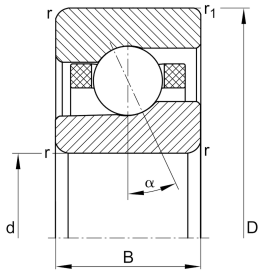

## Your current product variant

Contact angle	E	Contact angle $25^\circ$
Type of seal	Without	Not sealed
Cage	T	Laminated fabric cage
Tolerance class	P4S	Tolerance class P4S, FAG standard better than P4 to DIN 620
Arrangement bearing set	U	Single bearing
Preload	L	Preload light



## Main Dimensions &amp; Performance Data

d	65 mm	Bore diameter
D	100 mm	Outside diameter
B	18 mm	Width
$C_r$	19.200 N	Basic dynamic load rating, radial
$C_{0r}$	11.100 N	Basic static load rating, radial
$C_{ur}$	890 N	Fatigue load limit, radial
$n_G$ Grease	24.000 1/min	Limiting speed for grease lubrication
$n_G$ Oil	34.000 1/min	Limiting speed for oil lubrication
$\approx m$	408 g	Weight





### Mounting dimensions

$d_a$	72 mm	Diameter shaft shoulder
$d_a$	h12	Diameter shaft shoulder clearance
$D_a$	93 mm	Shoulder diameter outer ring
$D_a$	H12	Shoulder diameter outer ring clearance
$r_{a \max}$	1 mm	Maximum recess radius
$r_{a1 \max}$	0,6 mm	Maximum recess radius
$E_{tk \min}$	77,7 mm	Minimum diameter injection pitch
$E_{tk \max}$	80 mm	Maximum diameter injection pitch
$E_{tk1 \min}$	74,7 mm	Minimum diameter injection pitch
$E_{tk1 \max}$	80 mm	Maximum diameter injection pitch
$a$	28,2 mm	Distance between the apexes of the pressure cones

### Dimensions

$r_{\min}$	1,1 mm	Minimum chamfer dimension
$r_{1 \min}$	0,6 mm	Minimum chamfer dimension
$\alpha$	25 °	Contact angle

### Temperature range

$T_{\min}$	-30 °C	Operating temperature min.
$T_{\max}$	100 °C	Operating temperature max.



### Additional information

$F_{VL}$	129 N	Preload force light
$F_{VM}$	339 N	Preload force medium
$F_{VH}$	705 N	Preload force heavy
$K_{aEL}$	371 N	Lift-off force light
$K_{aEM}$	981 N	Lift-off force medium
$K_{aEH}$	2.067 N	Lift-off force heavy
$c_{aL}$	120 N/ $\mu$ m	Axial rigidity light
$c_{aM}$	169 N/ $\mu$ m	Axial rigidity medium
$c_{aH}$	220 N/ $\mu$ m	Axial rigidity heavy

### Characteristics

-  Radial load
-  Axial load in one direction
-  Grease Lubrication
-  Oil Lubrication
-  Not sealed