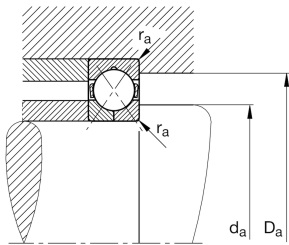
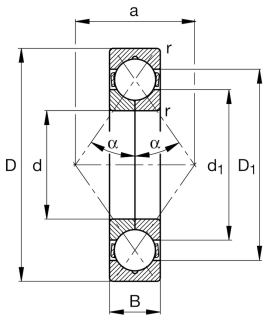

**FAG****QJ1048-MPA**

Four-point contact bearing

Four point contact bearing QJ10...-MPA, solid brass cage

Technical information

**Your current product variant**

Cage	MPA	Solid brass cage, outer ring guided
Tolerance class	PN	Tolerance class PN, acc. to DIN 620
Dimensional / heat stabilization	S1	Rings dimensional stabilized up to 200°
Axial internal clearance	CN	Group N (CN)

Main Dimensions & Performance Data

d	240 mm	Bore diameter
D	360 mm	Outside diameter
B	56 mm	Width
C_r	450.000 N	Basic dynamic load rating, radial
C_{0r}	790.000 N	Basic static load rating, radial
C_{ur}	25.500 N	Fatigue load limit, radial
n_G	3.050 1/min	Limiting speed
n_{gr}	1.530 1/min	Reference speed
m	21,4 kg	Weight

Mounting dimensions

$d_{a \min}$	252 mm	Minimum diameter shaft shoulder
$D_{a \max}$	348 mm	Maximum diameter of housing shoulder
$r_{a \max}$	2,5 mm	Maximum fillet radius







Dimensions

r_{\min}	3 mm	Minimum chamfer dimension
D_1	319,6 mm	Shoulder diameter outer ring
d_1	282,25 mm	Shoulder diameter inner ring
a	210,1 mm	Distance between the apexes of the pressure cones
α	35 °	Contact angle

Temperature range

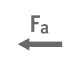
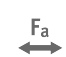
T_{\min}	-30 °C	Operating temperature min.
T_{\max}	200 °C	Operating temperature max.

Characteristics

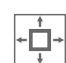
-  Radial load
-  Axial load in one direction
-  Axial load in two directions
-  Grease Lubrication
-  Oil Lubrication
-  Not sealed
-  Large bearing